



5808 Lake Washington Blvd. NE, Suite 200, Kirkland, WA 98033-7350
425-822-8880 • Fax: 425-889-8808

RECEIVED

SEP 06 2001

TRANSMITTAL FORM

DEPT OF ECOLOGY

To: Ann Kenny

Date: September 6, 2001

Department of Ecology

Project Number: 556-2912-001 01 03

3190 160th Avenue S.E.

Project Name: Port of Seattle

Bellevue, WA 98008

RECEIVED

SEP 06 2001

DEPT OF ECOLOGY

We are transmitting the following materials: Wetland hydrology monitoring data.

Comments:

- These are:
- PER YOUR REQUEST
 - FOR YOUR INFORMATION
 - FOR YOUR REVIEW AND APPROVAL
 - FOR YOUR FILES
 - FOR YOUR ACTION

- Sent Via:
- U.S. MAIL
 - COURIER
 - EXPRESS OVERNIGHT
 - OTHER - INTEROFFICE
 - HAND DELIVERY/PICK UP

Sincerely,

cc: Project File

AR 031263

Paul S. Fendt, P.E.

Lake Reba Area Water Level Data

	HC00-B151 Depth* levatio in Feet in Feet	HC00-B152 Depth* levatio in Feet in Feet	HC00-B155 Depth* levatio in Feet in Feet	AT97-B3 Depth* levatio in Feet in Feet	AT97-B14 Depth* levatio in Feet in Feet	AT97-B7 Depth* levatio in Feet in Feet
Measuring Poin	0.00 274.08	0.00 287.11	0.00 319.42			
Ground Level*	-0.6 274.68	-0.5 287.61	2.9 316.56			
Top of Screen*	6.5 267.6	17.1 270.0	25.5 294.0			
Bottom of Scree	11.5 262.6	27.1 260.0	35.5 284.0			
2/14/00	3.21 270.87	11.57 275.54	21.16 298.26			
3/10/00	3.01 271.07	11.67 275.44	21.01 298.41			
4/11/00	2.94 271.14	12.01 275.10	21.96 297.46			
5/9/00	2.75 271.33	12.11 275.00	22.87 296.55			
6/19/00	3.28 270.80	12.55 274.56	23.75 295.67			
7/10/00	3.49 270.59	12.61 274.50	24.16 295.26			
10/10/00	4.82 269.26	13.02 274.09	25.43 293.99			
1/22/01	3.34 270.74	12.31 274.80	24.12 295.30	9.56	19.97	5.37

AR 031264

ECY00019145

South Wall Area Water Level Data

Sheet 1 of 2

	AT94A-B1	AT97-B8	AT97-B59	AT97-B61	AT97-B63	HC00-B203	HC00-B205
	Depth* levatio in Feet in Feet	Depth* levatio in Feet in Feet	Depth* levatio in Feet in Feet	Depth* levatio in Feet in Feet	Depth* levatio in Feet in Feet	Depth* levatio in Feet in Feet	Depth* levatio in Feet in Feet
Measuring Point	0.00 356.2	0.00 379.2	0.00 312.9	0.00 328.0	0.00 330.5	0.00 310.95	0.00 306.
Ground Level*	1.2 355	2.2 377	2.9 310	3.0 325	2.5 328	2.0 309.0	2.8 303
Top of Screen*	74.2 282.0	15.2 364.0	22.4 290.5	32.0 296.0	42.0 288.5	33.0 278.0	12.8 293
Bottom of Scre	84.2 272.0	20.2 359.0	24.4 288.5	34.0 294.0	44.0 286.5	38.0 273.0	17.8 288
3/10/2000	62.50 293.7	4.65 374.6	14.35 298.6	33.01 295.0	37.94 292.6	25.32 285.63	13.55 292.1
4/11/00	62.51 293.7	5.50 373.7	14.87 298.0	33.40 294.6	37.98 292.5	25.63 285.32	16.45 289.
5/10/00	62.60 293.6	5.83 373.4	15.03 297.9	dry	38.03 292.5	25.82 285.13	dry
6/20/00	62.85 293.4	7.02 372.2	15.41 297.5	dry	38.19 292.3	26.19 284.76	16.6 289.5
7/10/00	62.93 293.3	7.88 371.3	15.59 297.3	dry	38.26 292.2	26.51 284.44	dry
10/10/00	63.49 292.7	10.39 368.8	16.18 296.7	dry	38.59 291.9	27.51 283.44	dry
1/23/01	63.68 292.5	6.26 372.9	15.94 297.0	dry	38.80 291.7	27.49 283.46	dry

Italics = Estimated

Depth* All depths are below measuring point (NOT below the ground surface)
 -- Indicates data not available.

AR 031265

ECY00019146

South Wall Area Water Level Data

	HC00-B208	HC00-B211	HC00-B213
	Depth* levatic in Feet in Feet	Depth* levatic in Feet in Feet	Depth* levatic in Feet in Feet
Measuring Poin	0.00 278.67	0.00 301.70	0.00 313.35
Ground Level*	2.4 276.3	2.3 299.4	2.4 311.0
Top of Screen*	29.9 248.8	16.3 285.4	12.4 301.0
Bottom of Scre	34.9 243.8	21.3 280.4	22.4 291.0
3/10/2000	0.43 278.24	1.51 300.19	15.47 297.88
4/11/00	0.6 278.07	2.2 299.50	16.08 297.27
5/10/00	0.71 277.96	2.29 299.41	16.22 297.13
6/20/00	0.98 277.69	2.96 298.74	16.37 296.98
7/10/00	1.14 277.53	3.42 298.28	16.48 296.87
10/10/00	1.62 277.05	4.31 297.39	16.81 296.54
1/23/01	1.61 277.06	2.52 299.18	16.71 296.64

1

AR 031266

ECY00019147

Elements of Shallow Groundwater Movement

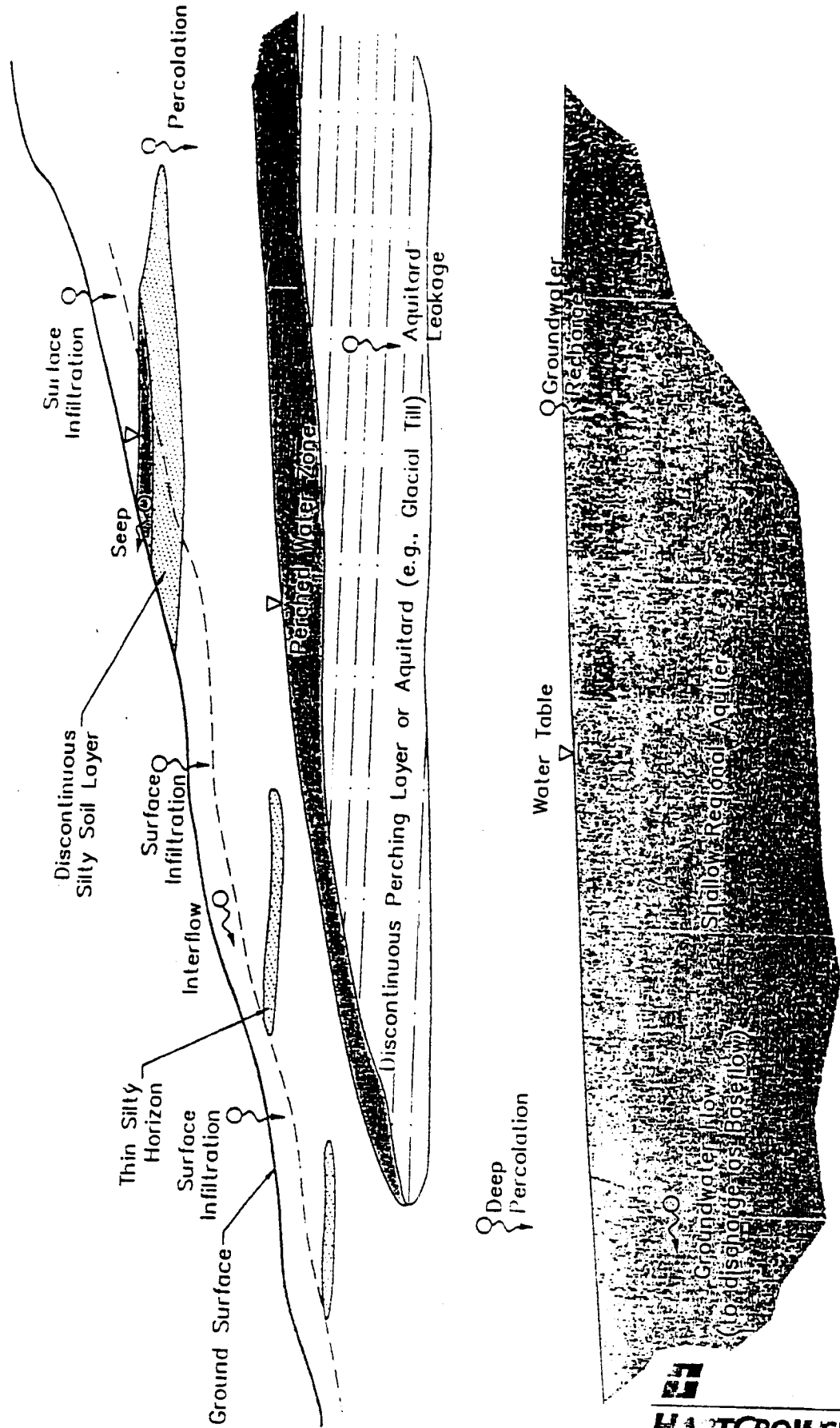

H.A. TROWER
 J-4978-08 7/99
 Figure 4

AR 031267

ECY00019148

HC 7/9/99 (4-1) 49720016

MSE Wall Schematic

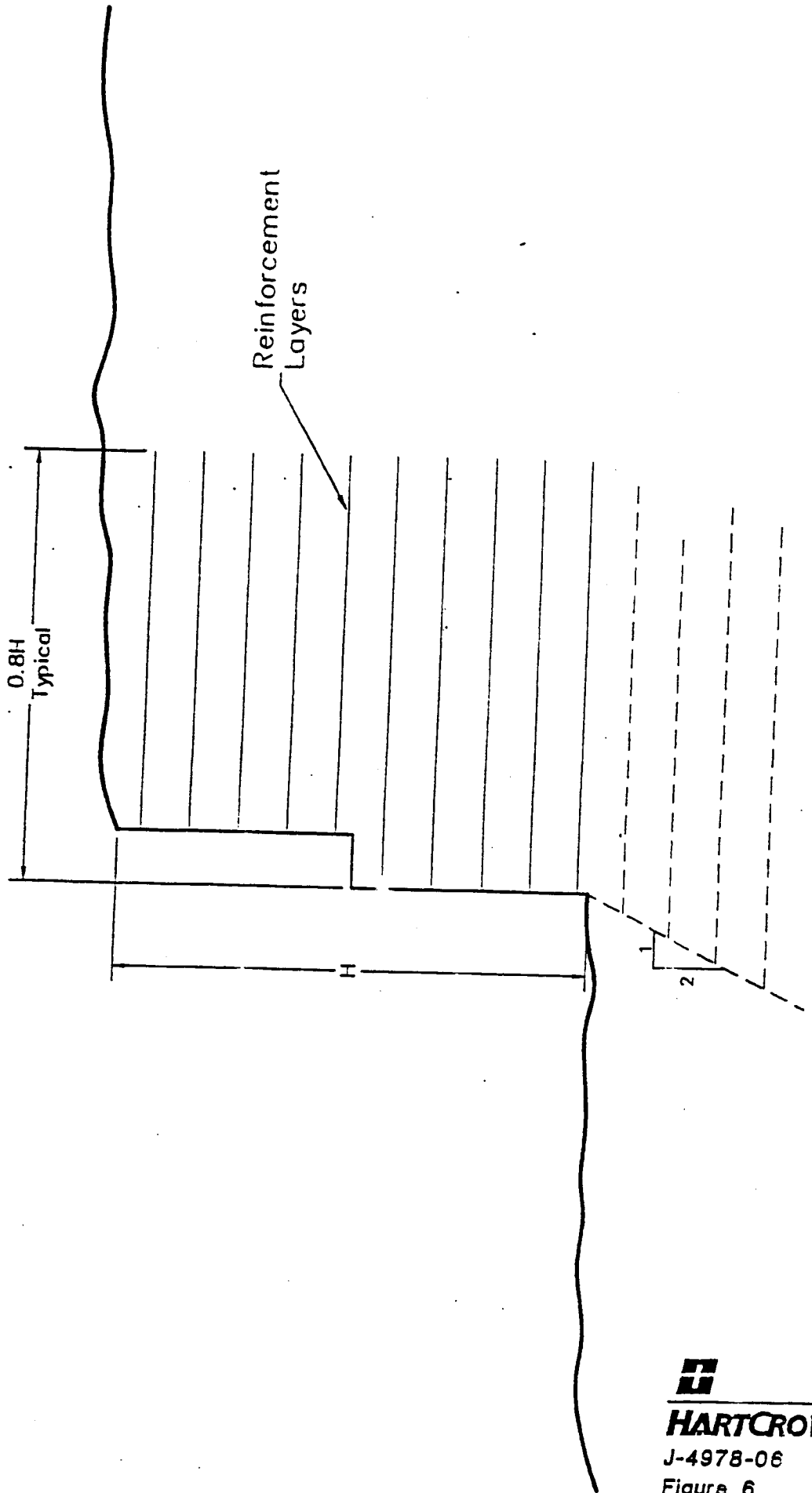

AR 031268



HARTCROW

J-4978-06 7/99

Figure 6

ECY00019149

Conceptual Zoned Embankment Cross Sections

EMBANKMENT ZONES

- A₁ PAVEMENT SUBGRADE
- A₂ DRAINAGE
- B₁ PAVEMENT SUPPORT
- B₂ MSE REINFORCING
- C₁ COMMON EMBANKMENT
- C₂ COMMON EMBANKMENT, SLOPE FACE
- D NON-STRUCTURAL FILL

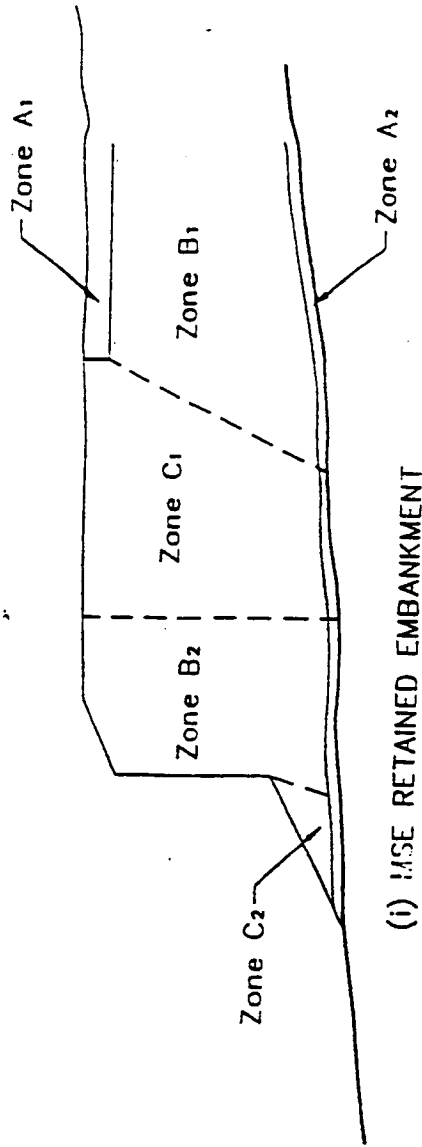

(i) MSE RETAINED EMBANKMENT

NOTE: DRAINAGE LAYER CONFIGURATION VARIES, SEE FIGURES 8 AND 9.

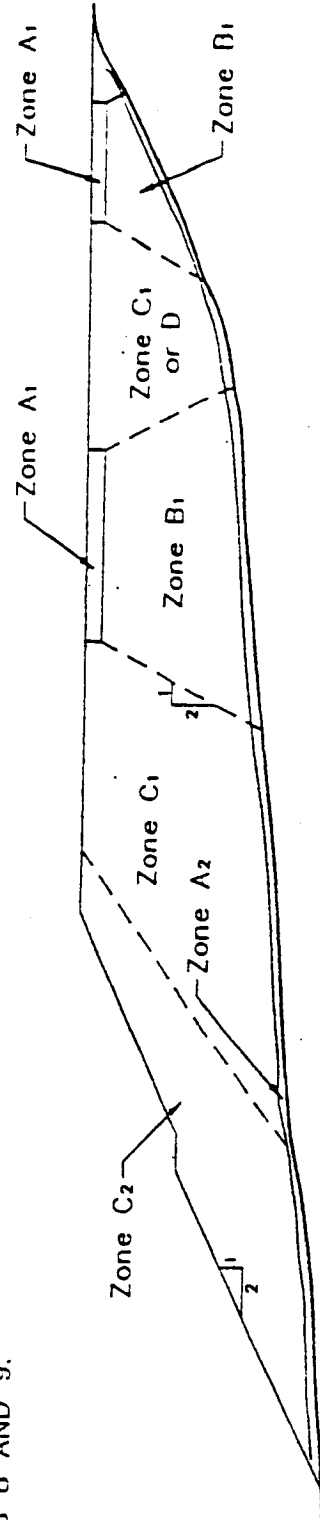

(ii) NOMINAL 2H:1V EMBANKMENT

AR 031269

Extent of Overexcavation for Replacement of Foundation Soils

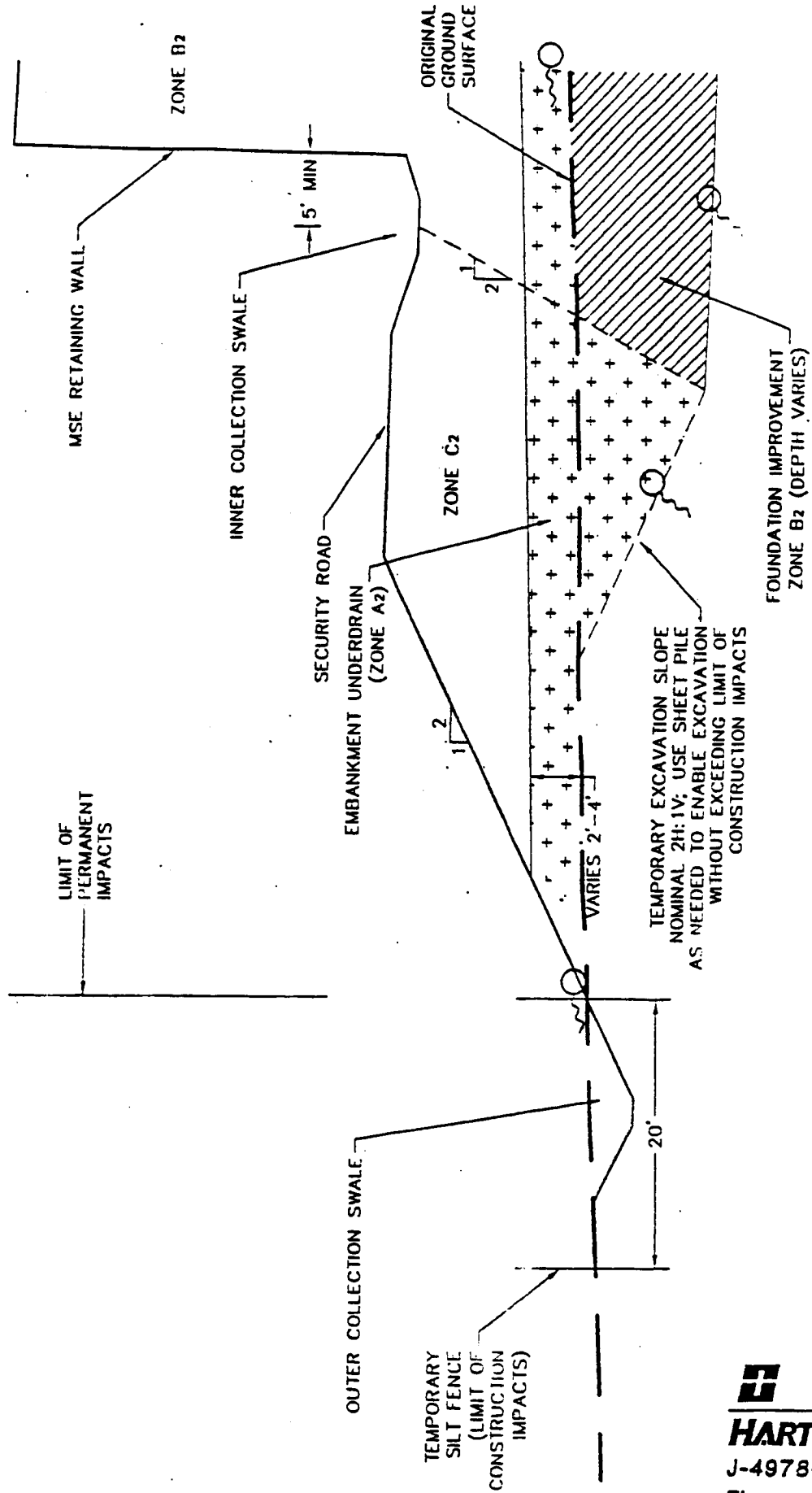

Hydraulic Connection between Wetland Fill and Embankment Underdrain

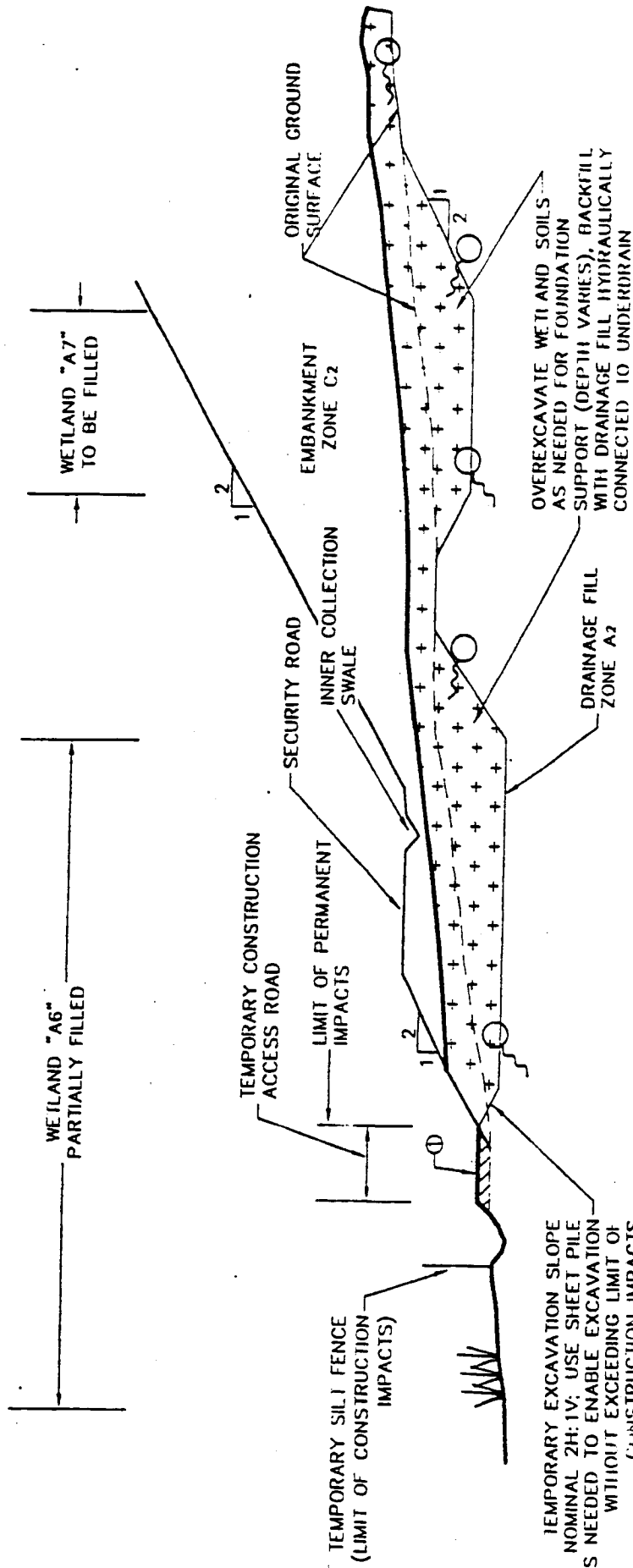

① TEMPORARY ROAD FILL TO BE REMOVED AFTER CONSTRUCTION

○ SEE PAGE

AR 031271

HARTCROWSER
J-4978-06 7/99

Figure 9

Water Balance Schematic between Stations 175+00 and 185+00 (Typical MSE Wall)

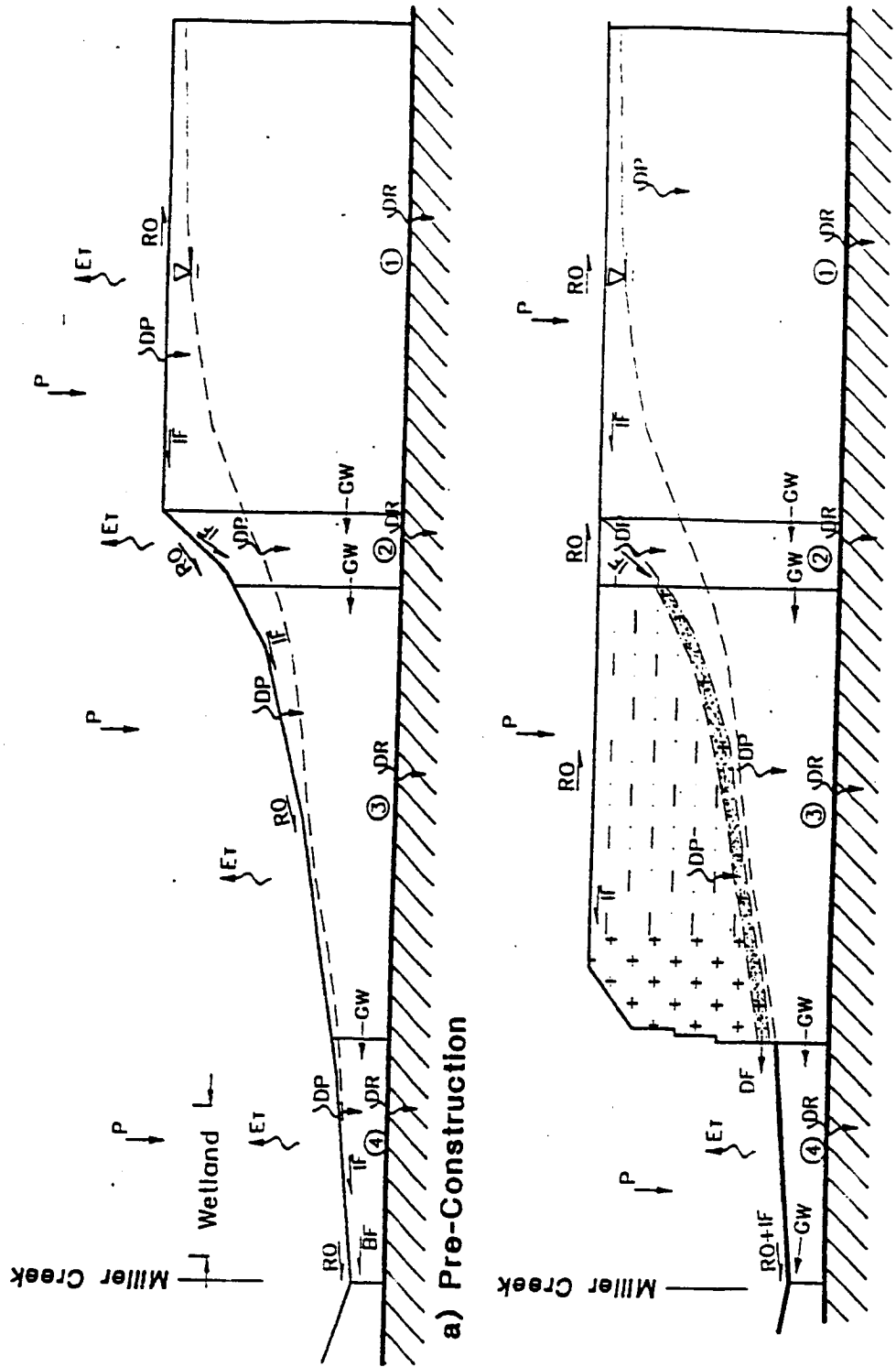

- ④ Block Number
- P Precipitation
- ET Evapotranspiration
- RO Runoff
- IF Interflow
- DP Deep Percolation
- GW Groundwater Flow
- DF Drainage Flow
- V Water Table
- DR Deep Recharge
- Drainage Layer
- New Embankment
- + + Free draining Backfill

AR 031272



J-4978-06 6/99
Figure B-1

Water Balance Schematic Between Stations 185+00 and 215+00 (Typical 2H:1V Embankment)

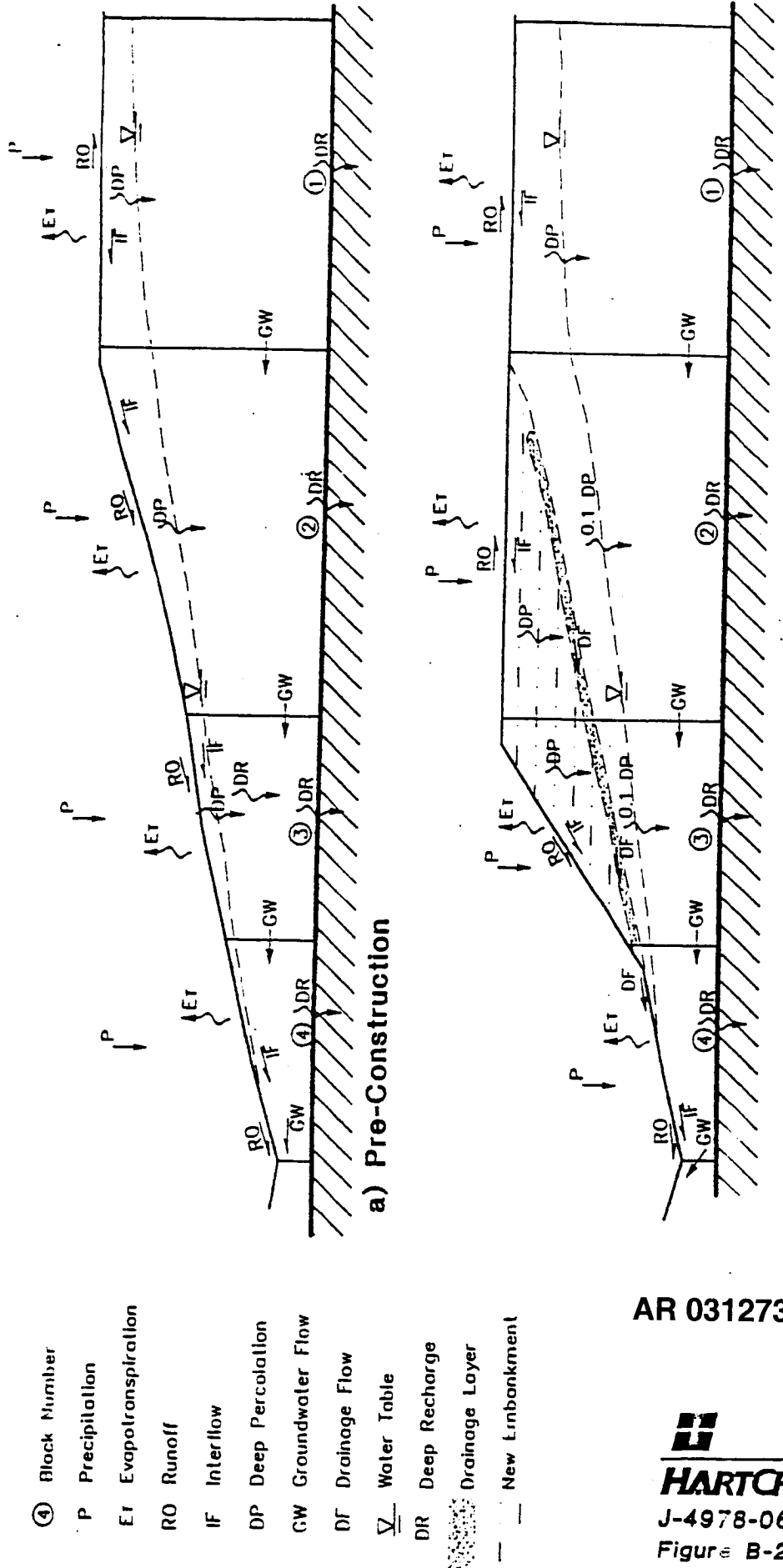

- ④ Block Number
- P Precipitation
- Et Evapotranspiration
- RO Runoff
- IF Interflow
- DP Deep Percolation
- GW Groundwater Flow
- DF Drainage Flow
- ▽ Water Table
- DR Deep Recharge
- DL Drainage Layer
- New Embankment

AR 031273

HARTCROWSE
 J-4978-08 7/9
 Figure B-2

West Wall Area Water Level Data

N/I saturation data

Hand Crossed

Measuring Point Ground Level* Top of Screen* Bottom of Screen	AT94A-B3		AT96-B4		AT97-B69		HC99-B37		HC99-B38		HC99-B39		HC99-B4	
	Depth* in Feet	levatio in Feet	Depth* in Feet	levatio in Feet	Depth* in Feet	levatio in Feet	Depth* in Feet	levatio in Feet	Depth* in Feet	levatio in Feet	Depth* in Feet	levatio in Feet	Depth* in Feet	levatio in Feet
	0.00	273.4	0.00	279.7	0.00	337.2	0.00	237.65	0.00	230.88	0.00	230.80	0.00	250
	1.4	272	-0.3	280	3.2	334	3.1	234.6	3.3	227.6	-0.3	231.1	-0.3	231.1
	23.4	250.0	36.7	243.0	27.7	310	9.1	228.6	12.3	218.6	4.7	226.1	4.7	226.1
	33.4	240.0	46.7	233.0	29.7	308	19.1	218.6	22.3	208.6	14.7	216.1	14.7	216.1
3/8/1999					--	--	3.52	234.13	4.40	226.48	0.69	230.11	0.69	230.11
3/10/99					6.18	331.0			4.41	226.47	0.74	230.06	0.74	230.06
4/5/99					6.59	330.6	3.58	234.07	4.60	226.28	0.86	229.94	0.86	229.94
5/4/99					7.43	329.8	3.82	233.83						
5/15/99					--	--	5.12	232.53						
6/14/99					8.08	329.1	4.72	232.93	5.90	224.98	1.68	229.12	1.68	229.12
7/13/99					8.41	328.8	5.70	231.95	5.93	224.95	2.05	228.75	2.05	228.75
8/13/99					8.83	328.4	6.47	231.18	6.08	224.80	2.18	228.62	2.18	228.62
9/14/99					9.16	328.0	4.50	233.15	6.48	224.40	2.51	228.29	2.51	228.29
10/13/99					9.12	328.1	3.22	234.43	5.98	224.90	2.09	228.71	2.09	228.71
11/11/99					8.13	329.1	3.27	234.38	4.25	226.63	2.90	227.90	2.90	227.90
12/9/99					6.80	330.4	3.20	234.45	4.38	226.50	0.27	230.53	0.27	230.53
1/13/00					6.48	330.7	3.12	234.53	4.35	226.53	0.54	230.26	0.54	230.26
2/14/00					6.54	330.7	3.17	234.48	4.33	226.55	0.59	230.21	0.59	230.21
3/9/00	Flowing > 272		Flowing > 280		6.82	330.4	3.17	234.48	4.43	226.45	0.61	230.19	0.61	230.19
4/11/00	Flowing > 272		Flowing > 280		7.45	329.8	3.35	234.30	4.60	226.28	0.88	229.92	0.88	229.92
5/10/00	Flowing > 272		Flowing > 280		7.78	329.4	3.19	234.46	4.32	226.56	0.88	229.92	0.88	229.92
6/19/00	-7.15	280.6	Flowing > 280		8.40	328.8	3.76	233.89	4.91	225.97	1.15	229.65	1.15	229.65
7/10/00	-6.00	279.4	-1.73	281.4	8.84	328.4	3.96	233.69	5.72	225.16	1.61	229.19	1.61	229.19
10/10/00	-1.38	274.8	-0.81	280.5	9.90	327.3	3.84	233.81	5.99	224.89	2.17	228.63	2.17	228.63
1/22/01	-8.30	281.7	-2.35	282.1	7.82	329.4	3.30	234.35	4.42	226.46	0.79	230.01	0.79	230.01

Italics = Estimated

Depth* All depths are below measuring point (NOT below the ground surface)

-- Indicates data not available.

West Wall Area Water Level Data

	HC00-B106	HC00-B111	HC00-B118	HC00-B120	HC00-B121	HC00-B123	HC00-B12
	Depth* levatic in Feetin	Depth* levatic in Feetin	Depth* levatic in Feetin	Depth* levatic in Feetin	Depth* levatic in Feetin	Depth* levatic in Feetin	Depth* levatic in Feetin
Measuring Point	0.00 315.81	0.00 286.06	0.00 298.61	0.00 236.93	0.00 231.78	0.00 237.64	0.00 237.64
Ground Level*	1.7 314.1	0.8 285.3	1.0 297.7	2.9 234.0	2.1 229.7	2.9 234.7	2.9 234.7
Top of Screen*	11.7 304.1	9.8 276.3	7.0 291.7	17.6 219.3	6.8 225.0	14.0 223.7	14.0 223.7
Bottom of Scree	21.7 294.1	19.8 266.3	12.0 286.7	22.6 214.3	16.8 215.0	24.0 213.7	24.0 213.7
3/8/1999							
3/10/99							
4/5/99							
5/4/99							
5/15/99							
6/14/99							
7/13/99							
8/13/99							
9/14/99							
10/13/99							
11/11/99							
12/9/99							
1/13/00							
2/14/00	5.49 310.32	6.80 279.26	6.63 291.98	5.1 231.83	0.80 230.98	2.06 235.58	2.06 235.58
3/9/00	5.50 310.31	6.94 279.12	6.71 291.90	4.92 232.01	0.62 231.16	1.90 235.74	1.90 235.74
4/11/00	6.21 309.60	8.34 277.72	7.84 290.77	5.52 231.41	1.09 230.69	2.25 235.39	2.25 235.39
5/10/00	6.38 309.43	8.59 277.47	7.64 290.97	6.1 230.83	1.53 230.25	2.61 235.03	2.61 235.03
6/19/00	7.04 308.77	9.17 276.89	8.52 290.09	6.23 230.70	1.53 230.25	2.59 235.05	2.59 235.05
7/10/00	7.47 308.34	9.95 276.11	9.12 289.49	4.87 232.06	0.52 231.26	1.90 235.74	1.90 235.74
10/10/00	8.52 307.29	10.83 275.23	9.85 288.76				
1/22/01	7.02 308.79	6.57 279.49	6.37 292.24				

AR 031275

ECY00019156

West Wall Area Water Level Data

Sheet 3 of 5

	HC00-B126	HC00-B129	HC00-B130	HC00-B132	HC00-B133	HC00-B137	HC00-B1
	Depth* levatic in Feet in Feet	Depth* levatic in Feet in Feet	Depth* levatic in Feet in Feet	Depth* levatic in Feet in Feet	Depth* levatic in Feet in Feet	Depth* levatic in Feet in Feet	Depth* levatic in Feet in Feet
Measuring Point	0.00 251.56	0.00 245.83	0.00 225.46	0.00 229.96	0.00 243.47	0.00 267.21	0.00 25
Ground Level*	1.4 250.2	2.6 243.2	2.3 223.1	2.6 227.4	2.4 241.1	2.8 264.5	0.9 2
Top of Screen*	8.4 243.2	9.6 236.2	7.3 218.1	13.6 216.4	7.4 236.1	9.8 257.5	12.9 2
Bottom of Scre	13.4 238.2	14.6 231.2	11.4 214.1	18.6 211.4	12.4 231.1	17.8 249.5	22.9 2
3/8/1999							
3/10/99							
4/5/99							
5/4/99							
5/15/99							
6/14/99							
7/13/99							
8/13/99							
9/14/99							
10/13/99							
11/11/99							
12/9/99							
1/13/00							
2/14/00	2.02 249.54	3.07 242.76	1.73 223.73	2.65 227.31	2.51 240.96	2.54 264.67	7.94 250
3/9/00	1.82 249.74	3.15 242.68	1.67 223.79	2.55 227.41	2.44 241.03	2.54 263.09	8.91 245
4/11/00	1.97 249.59	3.59 242.24	1.92 223.54	2.91 227.05	2.53 240.94	4.12 263.09	10.21 241
5/10/00	2.07 249.49	3.6 242.23	1.73 223.73	2.55 227.41	2.61 240.86	2.54 264.67	10.75 247
6/19/00	2.54 249.02	4.56 241.27	1.92 223.54	2.91 227.05	3.97 239.50	2.54 264.67	11.50 247
7/10/00	2.68 248.88	5.01 240.82	2.14 223.32	3.24 226.72	5.01 238.46	4.12 263.09	11.88 246
10/10/00	5.15 246.41	6.6 239.23	1.88 223.58	3.29 226.67	5.94 237.53	2.54 264.67	12.99 245
1/22/01	2.40 249.16	4.75 241.08	1.47 223.99	2.58 227.38	2.71 240.76	2.54 264.67	9.43 249

1

AR 031276

ECY00019157

West Wall Area Water Level Data

	HC00-B142 Depth* levatic in Feet in Feet	HC00-B143 Depth* levatic in Feet in Feet	HC00-B144 Depth* levatic in Feet in Feet	HC00-B145 Depth* levatic in Feet in Feet	HC00-B146 Depth* levatic in Feet in Feet	HC00-B301 Depth* levatic in Feet in Feet	HC00-B301 Depth* levatic in Feet in Feet
Measuring Point	0.00 272.72	0.00 242.27	0.00 248.99	0.00 265.11	0.00 263.55		
Ground Level*	2.7 270.1	3.2 239.1	2.4 246.6	2.3 262.8	2.9 260.7		
Top of Screen*	17.2 255.6	7.2 235.1	8.9 240.1	12.3 252.8	11.9 251.7		
Bottom of Screen	22.2 250.6	12.2 230.1	13.9 235.1	17.3 247.8	16.9 246.7		
3/8/1999							
3/10/99							
4/5/99							
5/4/99							
5/15/99							
6/14/99							
7/13/99							
8/13/99							
9/14/99							
10/13/99							
11/11/99							
12/9/99							
1/13/00							
2/14/00							
3/9/00	3.27 269.45			2.94 262.17			
4/11/00	3.53 269.19		2.98 246.01	3.14 261.97	3.81 259.74		
5/10/00	3.58 269.14		3.17 245.82	3.51 261.60	4.02 259.53		
6/19/00	4.57 268.15	4.23 238.04	3.00 245.99	3.18 261.93	3.79 259.76		
7/10/00	5.17 267.55	5.96 236.31	4.11 244.88	3.95 261.16	4.56 258.99		
10/10/00	6.19 266.53		5.76 243.23	4.59 260.52	5.92 257.63		
1/22/01	3.85 268.87	3.61 238.66	7.07 241.92	5.84 259.27	6.26 257.29	3.64	9.83
			3.11 245.88	3.38 261.73	3.63 259.92	2.44	8.99

1

AR 031277

West Wall Area Water Level Data

	HC00-B309	HC00-B316	HC00-B317	HC00-B315	HC00-B333
	Depth* levatio in Feet.in Feet	Depth* levatio in Feet.in Feet	Depth* levatio in Feet.in Feet	Depth* levatio in Feet.in Feet	Depth* levatio in Feet.in Feet
Measuring Poin	0.00	264.9	0.00	259.64	0.00
Ground Level*					
Top of Screen*				246.64	253.49
Bottom of Scree				236.64	263.49
3/8/1999					
3/10/99					
4/5/99					
5/4/99					
5/15/99					
6/14/99					
7/13/99					
8/13/99					
9/14/99					
10/13/99					
11/11/99					
12/9/99					
1/13/00					
2/14/00					
3/9/00					
4/11/00					
5/10/00					
6/19/00					
7/10/00					
10/10/00	35.66	9.49	10.01	7.18	8.03
1/22/01	35.30	8.58	8.75	252.46	275.46

Measurements in Inches. "0" = saturation to the surface; "x" = no data; "(+)" = depth of inundation.

Welland / Location	4/15/2000		2/22/2001		3/29/2001		5/1/2001		6/28/2001		7/31/2001	
	Depth to Saturation	Depth to Water	Depth to Saturation	Depth to Water	Depth to Saturation	Depth to Water	Depth to Saturation	Depth to Water	Depth to Saturation	Depth to Water	Depth to Saturation	Depth to Water
R13		0	14	14	>18	>18	>18	>18	>18	>18	>18	>18
R14	0	0	12	14	0	2	0	18	0	10	0	12
Borrow Areas												
B1			12	>18	>18	>18	>18	>18	>18	>18	>18	>18
B4			x	x	0	0	0	0	0	0	0	0
B5			>18	>18	>18	>18	flowing	>18	>18	>18	>18	>18
B6			>18	>18	>18	>18	dry	>18	>18	>18	>18	>18
B9	x	x	0	0	0	0	0	>18	>18	>18	>18	>18
B10	x	x	0	0	>18	>18	0	>18	>18	>18	>18	>18
B12			3	8	3	6	2	12	2	16	16	18
B15			3	6	0	0	>18	>18	>18	>18	>18	>18
29	x	x	0	0	0	0	0	16	0	8	4	10
30	x	x	0	(+).3*	0	0	>18	>18	>18	>18	>18	>18
32			x	x	3	7	>18	>18	>18	>18	>18	>18
48			0	0	0	0	12	>18	12	>18	>18	>18
Golf Course												
52					0	6	0	0	0	0	0	0
G5					0	3	2	>18	>18	>18	>18	>18
Wet 3							0	0	0	2.5	4	4
Wet 4							0	0	0	1.5	4	4
51												
Water A									>18	>18	>18	>18
					0.25							0.25

AR 031280

Pre-construction hydrologic conditions in wetlands near MPU construction sites.

Measurements in inches.

"0" = saturation to the surface; "x" = no data;

"(+)" = depth of inundation.

Wetland / Location	4/15/2000			2/22/2001			3/29/2001			5/1/2001			6/28/2001			7/31/2001		
	Depth to Saturation	Depth to Water	Inundation	Depth to Saturation	Depth to Water	Inundation	Depth to Saturation	Depth to Water	Inundation	Depth to Saturation	Depth to Water	Inundation	Depth to Saturation	Depth to Water	Inundation	Depth to Saturation	Depth to Water	Inundation
S-1	0	1		0	0		0	0	1	0	0		0	0		0	0	
S-2	0	5		0	5		0	4		0	0		0	0		0	0	
9-2																		
10					(+)3													
18-1	0	0		0	0		0	0	3	0	0		0	0		0	0	0.25
18-2	0	0		0	0		0	0	3	0	0		0	0		0	0	0.25
28-1	0	0		0	0		0	0	1	0	0		0	0		0	0	
28-2	0	9		0	3		0	0		dry	0		0	0		0	0	
28-3	0	16		3	6		0	0		>18	0		0	0		0	0	
28-4				3	6		10	12		14	16		15	16		15	16	
28-5										0	0		0	0		0	0	
28-6										0	0		0	0		0	0	
37-1	0	0		0	0		0	0		0	0		0	0		0	0	
37-2	0	0		0	0		0	0		>18	0		0	0		0	0	
37-3										12	18		16	18		16	18	
39-1	16	18		0	0		0	0	1	0	16		18	18		16	18	
39-2	6	12		1	2		0	0		0	0		0	0		0	0	
39-3	0	0		0	0		0	0		2	8		12	12		12	12	
39-4	0	0		x	x		0	0		3	8		8	12		8	12	
44-1	x	x		0	0		0	0		0	0		0	0		0	0	
44-2	x	x		0	0		0	0		0	0		0	0		0	0	
A-9	>18	>18		5	7		5	10		0	6		6	8		6	8	
A10	4	15		0	6		0	0		16	>18		12	>18(21)		12	>18	
A-11	>18	>18		11	12		12	19		6	>18		11	>18		11	>18	
A-12	0	0		0	0		2	4		3	>18		4	>18		4	>18	
A-13	x	x		12	14		>18	>18		0	4		0	10		0	10	
A-14a	0	0		0	0		0	0		4	>18		0	>18(19)		0	>18	
A-14b	0	3		0	4		0	0		0	10		2	7		2	7	
A-15	0	*		0	*		0	x		0	10		2	14		0	14	
A-16	9	14		0	2		0	2		0	>18		0	>18		0	>18	
R1				0	0		10	17		0	15		0	8		0	8	
R2				0	0		0	2.5		12	>18		12	18		12	18	
R4	x	x		0	0		0	1		0	12		12	>18		12	>18	
R5	x	x		10	10		10	12		0	14		11	16		11	16	
R6	x	x		0	0		0	0		0	>18		12	>18		12	>18	
R7a	x	x		4	6		10	12		4	12		6	15		6	15	
R9-1	0	0		0	0		0	0		8	>18		12	>18		12	>18	
R9-2	14	17		7	8		4	10		0	0		0	12		0	12	
R10	>18	>18		14	14		15	>18		>18	>18		12	16		12	16	
													16	>18		16	>18	

Measurements in Inches. "0" = saturation to the surface; "x" = no data; "(+)" = depth of inundation.

Welland / Location	4/15/2000		2/22/2001		3/29/2001		5/1/2001		6/28/2001		7/31/2001	
	Depth to Saturation	Depth to Water	Depth to Saturation	Depth to Water	Depth to Saturation	Depth to Water	Depth to Saturation	Depth to Water	Depth to Saturation	Depth to Water	Depth to Saturation	Depth to Water
R13	0	0	14	14	>18	>18	>18	>18	>18	>18	>18	>18
R14	0	0	12	14	0	2	0	18	0	10	0	12
Borrow Areas												
B1			12	>18	>18	>18	>18	>18	>18	>18	>18	>18
B4			x	x	0	0	0	0	0	0	0	0
B5			>18	>18	>18	>18	flowing	>18	>18	>18	>18	>18
B6			>18	>18	>18	>18	dry	>18	>18	>18	>18	>18
B9	x	x	0	0	0	0	0	0	0	0	0	0
B10	x	x	0	0	>18	>18	0	>18	>18	>18	>18	>18
B12			3	8	3	6	2	12	2	16	0	0
B15			3	6	0	0	>18	>18	>18	>18	>18	>18
29	x	x	0	0	0	0	0	16	0	8	4	10
30	x	x	0	(+), 3*	0	0	>18	>18	>18	>18	>18	>18
32			x	x	3	7	>18	>18	>18	>18	>18	>18
48			0	0	0	0	12	>18	12	>18	>18	>18
Golf Course												
52					0	6	0	0	0	6	0	0
G5					0	3	2	>18	>18	>18	>18	>18
Wet 3							0	0	0	2.5	4	4
Wet 4							0	0	0	1.5	4	4
51									>18	>18	>18	>18
Water A												0.5

AR 031282

ECY00019163

Borrow Area 4

Borrow Area 4 Water Level Data

	A4-B1		A4-B2		A4-B4		A4-B5		A4-B6	
	Depth* (feet)	Elevation (feet)	Depth* (feet)	Elevation (feet)	Depth* (feet)	Elevation (feet)	Depth* (feet)	Elevation (feet)	Depth* (feet)	Elevation (feet)
Top of Monument	-0.50	392.84	<i>NOT SURVEYED</i>		-0.35	385.71	-0.30	371.26	-0.26	401.48
Measuring Point	0.00	392.34	0.00	345	0.00	385.36	0.00	370.96	0.00	401.22
Ground Level*	1.94	390.4	2.00	343	2.36	383.0	2.66	368.3	2.72	398.5
Top of Screen*	109.44	282.90	12	333	97.86	287.50	72.86	298.10	118.52	282.70
Bottom of Well*	119.44	272.90	22	323	108.06	277.30	83.11	287.85	128.72	272.50
(ATD)	98.0	292.4	6.5	336.5						
Date: 12/28/94	100.2	290.2	9.9	333.1						
1/26/1995	102.3	288.1	10.9	332.1						
(ATD)					97.8	285.20	5.3	363.00	104.3	294.20
5/15/1998	--	--	--	--	--	--	--	--	--	--
5/22/1998	100.98	291.36	--	--	93.29	292.07	80.67	290.29	107.37	293.85
6/2/1998	100.70	291.64	--	--	92.98	292.38	80.43	290.53	106.92	294.30
6/15/1999	--	--	--	--	90.71	294.65	78.65	292.31	104.97	296.25
7/13/1999	--	--	--	--	91.09	294.27	78.80	292.16	105.23	295.99
8/13/1999	--	--	--	--	91.42	293.94	79.08	291.88	105.47	295.75
9/14/1999	--	--	--	--	91.82	293.54	79.28	291.68	105.80	295.42
10/13/1999	--	--	--	--	92.27	293.09	79.42	291.54	106.17	295.05
11/11/1999	100.20	292.14	--	--	92.60	292.76	79.75	291.21	106.61	294.61
12/10/1999	--	--	--	--	93.13	292.23	Dry	Dry	106.87	294.35
1/12/2000	--	--	--	--	93.48	291.88	80.56	290.40	107.15	294.07
2/15/2000	101.10	291.24	--	--	93.71	291.65	Dry	Dry	107.35	293.87
3/13/2000	101.03	291.31	--	--	93.58	291.78	80.72	290.24	107.23	293.99
4/12/2000	101.07	291.27	--	--	93.55	291.81	80.70	290.26	107.22	294.00
5/10/2000	101.01	291.33	--	--	93.46	291.90	80.69	290.27	107.21	294.01
6/21/2000	100.96	291.38	--	--	93.34	292.02	80.60	290.36	107.19	294.03
7/11/2000	100.95	291.39	--	--	93.34	292.02	80.62	290.34	107.17	294.05
10/13/2000	101.21	291.13	--	--	93.79	291.57	dry	dry	107.44	293.78
1/23/2001	101.67	290.67	--	--	94.52	290.84	dry	dry	108.01	293.21

Italics = Estimated

Depth* All depths are below measuring point (NOT below the ground surface)

-- Indicates data not available.

AR 031283

ECY00019164

Borrow Area 3 Water Level Data

ΔGIL Borings

	A3-B3		A3-B7		A3-B8		A3-B9		A3-B10		A3-B11	
	Depth* (feet)	Elevation (feet)	Depth* (feet)	Elevation (feet)	Depth* (feet)	Elevation (feet)	Depth* (feet)	Elevation (feet)	Depth* (feet)	Elevation (feet)	Depth* (feet)	Elevation (feet)
Top of Monument	-0.90	248.94	NOT SURVEYED	283.22	-0.35	283.22	-0.55	272.83	-0.30	321.44	-0.75	350.91
Measuring Point	0.00	248.04	0.00	317.0	0.00	282.87	0.00	272.28	0.00	321.14	0.00	350.15
Ground Level*	1.84	246.2	2.00	315.0	2.37	280.5	2.28	270.0	2.54	318.6	1.75	348.4
Top of Screen*	38.8	209.2	94.5	222.5	71.8	211.1	53.8	218.5	87.5	233.6	133.0	217.2
Bottom of Well*	50.8	197.2	104.5	212.5	82.3	200.6	64.2	208.1	97.8	223.3	143.3	206.5
Date: 12/28/94	35.1	211.1	87.3	227.7	--	--	--	--	--	--	--	--
1/26/1995	33.8	212.4	86.6	228.4	--	--	--	--	--	--	--	--
(ATD)												
5/15/1998	--	--	--	--	51.09	231.78	41.25	231.03	88.16	232.98	120.55	229.60
5/22/1998	29.94	218.10	--	--	51.16	231.71	41.15	231.13	88.76	232.98	120.35	229.80
6/2/1998	30.02	218.02	--	--	51.17	231.70	41.11	231.17	88.13	233.01	120.39	229.76
4/23/1999												
4/27/1999												
5/5/1999												
6/14/1999	28.28	219.76	--	--	50.13	232.74	39.69	232.59	87.01	234.13	119.32	230.83
7/13/1999	29.10	218.94	--	--	49.66	233.21	40.13	232.15	88.79	232.35	120.06	230.09
8/13/1999	29.93	218.11	--	--	50.48	232.39	40.89	231.39	89.50	231.64	120.79	229.36
9/14/1999	29.71	218.33	--	--	51.03	231.84	41.21	231.07	88.67	232.47	120.93	229.22
10/13/1999	31.40	216.64	--	--	51.80	231.07	41.82	230.46	89.09	232.05	121.27	228.88
11/11/1999	31.96	216.08	--	--	52.66	230.21	41.92	230.36	88.62	232.52	120.14	230.01
12/10/1999	31.96	216.08	--	--	52.27	230.60	41.99	230.29	88.35	232.79	120.51	229.64
1/12/2000	30.09	217.95	--	--	--	--	41.30	230.98	87.57	233.57	119.71	230.44
2/15/2000	30.54	217.50	--	--	51.15	231.72	41.23	231.05	87.60	233.54	119.75	230.40
3/13/2000	29.78	218.26	--	--	50.53	232.34	40.44	231.84	87.18	233.96	119.35	230.80
4/12/2000	29.20	218.84	--	--	50.5	232.37	40.69	231.59	87.56	233.58	119.78	230.37
5/10/2000	29.57	218.47	--	--	50.95	231.92	40.97	231.31	87.89	233.25	120.12	230.03
6/21/2000	30.38	217.66	--	--	52.01	230.86	41.94	230.34	89.09	232.05	121.34	228.81
7/11/2000	30.83	217.21	--	--	52.74	230.13	42.47	229.81	89.63	231.51	121.88	228.27
10/13/2000	33.16	214.88	--	--	56.16	226.71	44.60	227.68	91.10	230.04	123.27	226.88
1/23/2001	35.00	213.04	--	--	56.77	226.10	44.96	227.32	90.99	230.15	123.10	227.05

Italics = Estimated

Depth* All depths are below measuring point (NOT below the ground surface)

-- Indicates data not available.

AR 031284

Borrow Area 3 Water Level Data

	A3-B12		A3-B13-99		A3-B14-99		A3-B15-99		A3-B16-99		A3-B17-99	
	Depth* (feet)	Elevation (feet)	Depth* in Feet	Elevation in Feet	Depth* in Feet	Elevation in Feet	Depth* in Feet	Elevation in Feet	Depth* in Feet	Elevation in Feet	Depth* in Feet	Elevation in Feet
Top of Monument	-0.40	244.32	-0.31	286.66	-0.28	293.28	-0.26	303.28	-0.61	346.63	-0.48	304.86
Measuring Point	0.00	243.92	0.00	286.35	0.00	293.00	0.00	303.02	0.00	346.02	0.00	304.38
Ground Level*	2.82	241.1	1.5	284.9	2.5	290.5	3.3	299.7	2.0	344.0	1.8	302.6
Top of Screen*	27.6	216.3	54.5	231.9	37.5	255.5	22.3	280.7	55.0	291.0	18.3	286.1
Bottom of Well*	37.9	206.0	59.5	226.9	42.5	250.5	27.3	275.7	60.0	286.0	23.3	281.1
Date: 12/28/94	--	--	--	--	--	--	--	--	--	--	--	--
1/26/1995	--	--	--	--	--	--	--	--	--	--	--	--
(ATD)												
5/15/1998	20.03	223.89	54.5	231.85	38.0	255.00	21.5	281.52	51.0	295.02	18.0	286.38
5/22/1998	20.21	223.71										
6/2/1998	20.39	223.53										
4/23/1999												
4/27/1999												
5/5/1999												
6/14/1999	18.71	225.21	54.65	231.70	37.75	255.25	21.81	281.21	50.6	295.42	18.25	286.13
7/13/1999	19.65	224.27	54.69	231.66	37.73	255.27	21.44	281.58	50.65	295.37	18.37	286.01
8/13/1999	20.63	223.29	54.87	231.48	37.87	255.13	21.66	281.36	50.76	295.26	18.59	285.79
9/14/1999	21.57	222.35	55.52	230.83	38.60	254.40	22.28	280.74	51.23	294.79	19.37	285.01
10/13/1999	22.28	221.64	55.94	230.41	39.01	253.99	22.85	280.17	51.82	294.20	19.88	284.50
11/11/1999	22.70	221.22	56.45	229.90	39.23	253.77	23.41	279.61	52.54	293.48	20.43	283.95
12/10/1999	21.63	222.29	57.08	229.27	38.08	254.92	23.88	279.14	53.16	292.86	20.97	283.41
1/12/2000	20.45	223.47	57.79	228.56	40.41	252.59	24.37	278.65	53.79	292.23	21.59	282.79
2/15/2000	19.88	224.04	58.71	227.64	41.05	251.95	24.62	278.40	54.23	291.79	22.02	282.36
3/13/2000	19.20	224.72	58.87	227.04	39.96	253.04	23.72	279.30	54.76	291.26	22.15	282.23
4/12/2000	19.26	224.66	58.51	227.48	39.39	253.61	23.40	279.62	54.78	291.24	21.61	282.77
5/10/2000	19.87	224.05	58.02	228.33	38.59	254.41	22.88	280.14	54.65	291.37	20.76	283.62
6/21/2000	20.81	223.11	57.53	228.82	39.35	253.65	22.38	280.64	54.20	291.82	19.90	284.48
7/11/2000	21.37	222.55	57.87	228.48	40.11	252.89	22.99	280.03	53.97	292.05	20.19	284.19
10/13/2000	23.69	220.23	58.69	227.66	40.61	252.39	23.43	279.59	53.92	292.10	20.62	283.76
1/23/2001	24.14	219.78	59.12	227.23	40.92	252.08	23.90	279.12	54.33	291.69	21.34	283.04
			dry	dry	dry	dry	24.21	278.81	54.51	291.51	21.71	282.67
			dry	dry	dry	dry	25.27	277.75	55.43	290.59	dry	dry
			dry	dry	dry	dry	25.01	278.01	56.42	289.60	dry	dry

AR 031285

ECY00019166

Borrow Area I

Borrow Area I Water Level Data

	AGI Borings		A1-B9-94		Hart Crowser Borings		A1-B11-99		A1-B12-99	
	Depth* in Feet	Elevation in Feet	Depth* in Feet	Elevation in Feet	Depth* in Feet	Elevation in Feet	Depth* in Feet	Elevation in Feet	Depth* in Feet	Elevation in Feet
Top of Monument	-0.25	304.67	-0.25	279.29	-0.68	273.30	-0.35	322.41	-0.25	324.78
Measuring Point (Top of Casing)	0.00	304.42	0.00	279.04	0.00	272.90	0.00	322.06	0.00	324.53
Ground Level (Stick-Up)	1.90	302.5	1.52	277.5						
Top of Screen (below GS)	43.0	259.5	53.0	224.5	59.0	213.9	55.0	267.1	79.0	245.5
Bottom of Well (below GS)	53.5	249.0	63.0	214.5	69.0	203.9	65.0	257.1	89.0	235.5
Water Levels										
12/28/1994	30.5	272.02	49.9	227.62						
1/26/1995	29.5	273.02	48.7	228.82						
(ATD)										
2/16/1999	28.57	275.85	47.34	231.70	52.7	220.20	41.0	281.06	62.0	262.53
2/19/1999	28.94	275.48	46.71	232.33	52.8	220.10	41.25	280.81	61.1	263.43
5/5/1999	29.22	275.20	47.60	231.44	53.10	219.80	41.08	280.98	61.55	262.98
6/14/1999	29.65	274.77	48.24	230.80	53.87	219.03	40.84	281.22	60.56	263.97
7/15/1999	30.00	274.42	48.71	230.33	53.65	219.25	40.84	281.22	59.90	264.63
8/13/1999	30.21	274.21	49.20	229.84	54.20	218.70	41.23	280.83	60.04	264.49
9/14/1999	30.52	273.90	49.52	229.52	54.70	218.20	41.52	280.54	60.24	264.29
10/13/1999	30.85	273.57	49.36	229.68	54.99	217.91	41.79	280.27	60.33	264.20
11/11/1999	30.16	274.26	49.00	230.04	55.50	217.40	42.19	279.87	60.71	263.82
12/10/1999	29.10	275.32	48.65	230.39	55.62	217.28	42.60	279.46	61.60	262.93
1/12/2000	28.84	275.58	48.40	230.64	55.16	217.74	41.97	280.09	61.30	263.23
2/15/2000	28.45	275.97	47.99	231.05	54.31	218.59	41.26	280.80	60.96	263.57
3/10/2000	28.52	275.90	48.08	230.96	53.85	219.05	41.23	280.83	61.32	263.21
4/12/2000	28.79	275.63	48.30	230.74	53.34	219.56	40.92	281.14	61.09	263.44
5/10/2000	29.56	274.86	49.12	229.92	53.40	219.50	40.76	281.30	60.58	263.95
6/21/2000	29.78	274.64	49.52	229.52	53.83	219.07	40.64	281.42	60.05	264.48
7/11/2000	30.89	273.53	50.94	228.10	54.71	218.19	41.28	280.78	60.25	264.28
10/13/2000	30.94	273.48	51.00	228.04	55.09	217.81	41.49	280.57	60.30	264.23
1/23/2001					56.79	216.11	42.79	279.27	61.16	263.37
					56.95	215.95	42.58	279.48	61.72	262.81

Notes:

- 1) AGI Borings have stick-up monuments
- 2) Hart Crowser borings are completed with flush monuments
- 3) Water levels are measured as depths below the Measuring Point
- 4) Measuring Point is top of PVC casing
- 5) -- Indicates data not available.

AR 031286

Borrow Area 1

Borrow Area 1 Water Level Data

		Hart Crowser Borings					
		A1-B12S-99		A1-B13-99		A1-B14-99	
		Depth* in Feet	Elevation in Feet	Depth* in Feet	Elevation in Feet	Depth* in Feet	Elevation in Feet
Top of Monument	(Monument)	-0.40	324.64	-0.58	288.57	-0.45	283.25
Measuring Point	(Top of Casing)	0.00	324.24	0.00	287.99	0.00	282.80
Ground Level	(Stick-Up)						
Top of Screen	(below GS)	59.0	265.2	58.9	229.1	55.0	227.8
Bottom of Well	(below GS)	64.0	260.2	69.2	218.8	65.0	217.8
Water Levels	12/28/1994						
	1/26/1995						
	(ATD)	61.5	262.74	62.5	225.49	53.0	229.80
	2/16/1999	--	--	41.9	246.09	52.6	230.20
	2/19/1999	61.26	262.98	40.33	247.66	53.41	229.39
	5/5/1999	60.53	263.71	39.76	248.23	52.44	230.36
	6/14/1999	59.93	264.31	40.33	247.66	53.17	229.63
	7/15/1999	59.97	264.27	40.96	247.03	53.16	229.64
	8/13/1999	60.03	264.21	41.46	246.53	53.80	229.00
	9/14/1999	60.12	264.12	41.75	246.24	54.15	228.65
	10/13/1999	60.41	263.83	42.20	245.79	54.22	228.58
	11/11/1999	60.72	263.52	42.20	245.79	54.27	228.53
	12/10/1999	60.93	263.31	41.92	246.07	53.91	228.89
	1/12/2000	60.85	263.39	41.30	246.69	53.27	229.53
	2/15/2000	61.06	263.18	41.03	246.96	53.28	229.52
	3/10/2000	60.95	263.29	40.48	247.51	52.86	229.94
	4/12/2000	60.55	263.69	40.46	247.53	52.83	229.97
	5/10/2000	60.20	264.04	40.66	247.33	52.93	229.87
	6/21/2000	60.18	264.06	41.52	246.47	53.63	229.17
	7/11/2000	60.17	264.07	42.00	245.99	54.13	228.67
	10/13/2000	60.84	263.40	43.51	244.48	55.38	227.42
	1/23/2001	61.49	262.75	43.36	244.63	55.15	227.65

AR 031287

South Wall Area Water Level Data

	AT94A-B1	AT97-B8	AT97-B59	AT97-B61	AT97-B63	HC00-B203	HC00-B205
	Depth* Elevation in Feet in Feet	Depth* Elevation in Feet in Feet	Depth* Elevation in Feet in Feet	Depth* Elevation in Feet in Feet	Depth* Elevation in Feet in Feet	Depth* Elevation in Feet in Feet	Depth* Elevation in Feet in Feet
Measuring Point	0.00 356.2	0.00 379.2	0.00 312.9	0.00 328.0	0.00 330.5	0.00 310.95	0.00 306.0
Ground Level*	1.2 355	2.2 377	2.9 310	3.0 325	2.5 328	2.0 309.0	2.8 303
Top of Screen*	74.2 282.0	15.2 364.0	22.4 290.5	32.0 296.0	42.0 288.5	33.0 278.0	12.8 293
Bottom of Screen*	84.2 272.0	20.2 359.0	24.4 288.5	34.0 294.0	44.0 286.5	38.0 273.0	17.8 288
Date:							
3/10/2000	62.50 293.7	4.65 374.6	14.35 298.6	33.01 295.0	37.94 292.6	25.32 285.63	13.55 292.4
4/11/2000	62.51 293.7	5.50 373.7	14.87 298.0	33.40 294.6	37.98 292.5	25.63 285.32	16.45 289.0
5/10/2000	62.60 293.6	5.83 373.4	15.03 297.9	dry	38.03 292.5	25.82 285.13	dry
6/20/2000	62.85 293.4	7.02 372.2	15.41 297.5	dry	38.19 292.3	26.19 284.76	16.6 289.0
7/10/2000	62.93 293.3	7.88 371.3	15.59 297.3	dry	38.26 292.2	26.51 284.44	dry
10/10/2000	63.49 292.7	10.39 368.8	16.18 296.7	dry	38.59 291.9	27.51 283.44	dry
1/23/2001	63.68 292.5	6.26 372.9	15.94 297.0	dry	38.80 291.7	27.49 283.46	dry

Italics = Estimated

Depth* All depths are below measuring point (NOT below the ground surface)

-- Indicates data not available.

AR 031288

ECY00019169

South Wall Area Water Level Data

	HC00-B208		HC00-B211		HC00-B213	
	Depth*	Elevation	Depth*	Elevation	Depth*	Elevation
	in Feet	in Feet	in Feet	in Feet	in Feet	in Feet
Measuring Point	0.00	278.67	0.00	301.70	0.00	313.35
Ground Level*	2.4	276.3	2.3	299.4	2.4	311.0
Top of Screen*	29.9	248.8	16.3	285.4	12.4	301.0
Bottom of Screen*	34.9	243.8	21.3	280.4	22.4	291.0
Date:						
	3/10/2000	278.24	1.51	300.19	15.47	297.88
	4/11/2000	278.07	2.2	299.50	16.08	297.27
	5/10/2000	277.96	2.29	299.41	16.22	297.13
	6/20/2000	277.69	2.96	298.74	16.37	296.98
	7/10/2000	277.53	3.42	298.28	16.48	296.87
	10/10/2000	277.05	4.31	297.39	16.81	296.54
	1/23/2001	277.06	2.52	299.18	16.71	296.64

AR 031289

ECY00019170

Lake Reba Area Water Level Data

Sheet 1 of 1

Measuring Point	HC00-B151		HC00-B152		HC00-B155		AT97-B3		AT97-B14		AT97-B?	
	Depth* in Feet	Elevation in Feet	Depth* in Feet	Elevation in Feet	Depth* in Feet	Elevation in Feet	Depth* in Feet	Elevation in Feet	Depth* in Feet	Elevation in Feet	Depth* in Feet	Elevation in Feet
Ground Level*	0.00	274.08	0.00	287.11	0.00	319.42						
Top of Screen*	-0.6	274.68	-0.5	287.61	2.9	316.56						
Bottom of Screen*	6.5	267.6	17.1	270.0	25.5	294.0						
	11.5	262.6	27.1	260.0	35.5	284.0						
Date: 2/14/00												
3/10/2000	3.21	270.87	11.57	275.54	21.16	298.26						
4/11/2000	3.01	271.07	11.67	275.44	21.01	298.41						
5/9/2000	2.94	271.14	12.01	275.10	21.96	297.46						
6/19/2000	2.75	271.33	12.11	275.00	22.87	296.55						
7/10/2000	3.28	270.80	12.55	274.56	23.75	295.67						
10/10/2000	3.49	270.59	12.61	274.50	24.16	295.26						
1/22/2001	4.82	269.26	13.02	274.09	25.43	293.99						
	3.34	270.74	12.31	274.80	24.12	295.30	9.56		19.97		5.37	

AR 031290

ECY00019171

West Wall Area Water Level Data

Sheet 1 of 5

Measuring Point	AT94A-B3		AT96-B4		AT97-B69		HC99-B37		HC99-B38		HC99-B39		HC99-B40	
	Depth* in Feet	Elevation in Feet	Depth* in Feet	Elevation in Feet	Depth* in Feet	Elevation in Feet	Depth* in Feet	Elevation in Feet	Depth* in Feet	Elevation in Feet	Depth* in Feet	Elevation in Feet	Depth* in Feet	Elevation in Feet
Ground Level*	0.00	273.4	0.00	279.7	0.00	337.2	0.00	237.65	0.00	230.88	0.00	230.80	0.00	250
Top of Screen*	1.4	272	-0.3	280	3.2	334	3.1	234.6	3.3	227.6	-0.3	231.1	-0.3	241
Bottom of Screen*	23.4	250.0	36.7	243.0	27.7	310	9.1	228.6	12.3	218.6	4.7	226.1	4.7	230
	33.4	240.0	46.7	233.0	29.7	308	19.1	218.6	22.3	208.6	14.7	216.1	14.7	230
Date:	3/8/1999													220
	3/10/1999				6.18	331.0	3.52	234.13	4.40	226.48	0.69	230.11	0.69	245
	4/5/1999				6.59	330.6	3.58	234.07	4.41	226.47	0.74	230.06	0.74	245
	5/4/1999				7.43	329.8	3.82	233.83	4.60	226.28	0.86	229.94	0.86	244.1
	5/15/1999													
	6/14/1999													
	7/13/1999				8.08	329.1	5.12	232.53	5.90	224.98	1.68	229.12	1.68	243
	8/13/1999				8.41	328.8	4.72	232.93	5.93	224.95	2.05	228.75	2.05	243
	9/14/1999				8.83	328.4	5.70	231.95	6.08	224.80	2.18	228.62	2.18	243
	10/13/1999				9.16	328.0	6.47	231.18	6.48	224.40	2.51	228.29	2.51	242
	11/11/1999				9.12	328.1	4.50	233.15	5.98	224.90	2.09	228.71	2.09	243
	12/9/1999				8.13	329.1	3.22	234.43	4.25	226.63	2.90	227.90	2.90	244
	1/13/2000				6.80	330.4	3.27	234.38	4.38	226.50	0.27	230.53	0.27	245
	2/14/2000				6.48	330.7	3.20	234.45	4.35	226.53	0.54	230.26	0.54	245
	3/9/2000	Flowing	>272	Flowing	6.54	330.7	3.12	234.53	4.33	226.55	0.59	230.21	0.59	246
	4/11/2000	Flowing	>272	Flowing	6.82	330.4	3.17	234.48	4.43	226.45	0.61	230.19	0.61	245
	5/10/2000	Flowing	>272	Flowing	7.45	329.8	3.35	234.30	4.60	226.28	0.88	229.92	0.88	245
	6/19/2000	Flowing	>272	Flowing	7.78	329.4	3.19	234.46	4.32	226.56	0.88	229.92	0.88	245
	7/10/2000	-7.15	280.6	Flowing	8.40	328.8	3.76	233.89	4.91	225.97	1.15	229.65	1.15	244
	10/10/2000	-6.00	279.4	-1.73	8.84	328.4	3.96	233.69	5.72	225.16	1.61	229.19	1.61	244
	1/22/2001	-1.38	274.8	-0.81	9.90	327.3	3.84	233.81	5.99	224.89	2.17	228.63	2.17	242
		-8.30	281.7	-2.35	7.82	329.4	3.30	234.35	4.42	226.46	0.79	230.01	0.79	245

Italics = Estimated

Depth* All depths are below measuring point (NOT below the ground surface)
 .. Indicates data not available.

AR 031291

ECY00019172

4078706-1-1-00-1

West Wall Area Water Level Data

Sheet 2 of 5

	HC00-B106		HC00-B111		HC00-B118		HC00-B120		HC00-B121		HC00-B123		HC00-B125	
	Depth*	Elevation	Depth*	Elevation	Depth*	Elevation	Depth*	Elevation	Depth*	Elevation	Depth*	Elevation	Depth*	Elevation
	in Feet	in Feet	in Feet	in Feet	in Feet	in Feet	in Feet	in Feet	in Feet	in Feet	in Feet	in Feet	in Feet	in Feet
Measuring Point	0.00	315.81	0.00	286.06	0.00	298.61	0.00	236.93	0.00	231.78	0.00	237.64	0.00	257
Ground Level*	1.7	314.1	0.8	285.3	1.0	297.7	2.9	234.0	2.1	229.7	2.9	234.7	-0.4	258
Top of Screen*	11.7	304.1	9.8	276.3	7.0	291.7	17.6	219.3	6.8	225.0	14.0	223.7	3.6	254
Bottom of Screen*	21.7	294.1	19.8	266.3	12.0	286.7	22.6	214.3	16.8	215.0	24.0	213.7	8.6	249
Date:	3/8/1999													
	3/10/1999													
	4/5/1999													
	5/4/1999													
	5/15/1999													
	6/14/1999													
	7/13/1999													
	8/13/1999													
	9/14/1999													
	10/13/1999													
	11/11/1999													
	12/9/1999													
	1/13/2000													
	2/14/2000	5.49	310.32	6.80	279.26	6.63	291.98	5.1	231.83	0.80	230.98	2.06	235.58	3.74
	3/9/2000	5.50	310.31	6.94	279.12	6.71	291.90	4.92	232.01	0.62	231.16	1.90	235.74	3.89
	4/11/2000	6.21	309.60	8.34	277.72	7.84	290.77	5.52	231.41	1.09	230.69	2.25	235.39	4.79
	5/10/2000	6.38	309.43	8.59	277.47	7.64	290.97	6.1	230.83	1.53	230.25	2.61	235.01	6.39
	6/19/2000	7.04	308.77	9.17	276.89	8.52	290.09	6.23	230.70	1.53	230.25	2.59	235.05	6.83
	7/10/2000	7.47	308.34	9.95	276.11	9.12	289.49	4.87	232.06	0.52	231.26	1.90	235.74	5.66
	10/10/2000	8.52	307.29	10.83	275.23	9.85	288.76							
	1/22/2001	7.02	308.79	6.57	279.49	6.37	292.24							

AR 031292

ECY00019173

West Wall Area Water Level Data

Sheet 4 of 5

	HC00-B142	HC00-B143	HC00-B144	HC00-B145	HC00-B146	HC00-B301	HC00-B308
	Depth* in Feet	Elevation in Feet	Depth* in Feet	Elevation in Feet	Depth* in Feet	Elevation in Feet	Depth* in Feet
Measuring Point	0.00	272.72	0.00	242.27	0.00	265.11	0.00
Ground Level*	2.7	270.1	2.4	246.6	2.3	262.8	2.9
Top of Screen*	17.2	255.6	8.9	240.1	12.3	252.8	11.9
Bottom of Screen*	22.2	250.6	13.9	235.1	17.3	247.8	16.9
Date:	3/8/1999						
	3/10/1999						
	4/5/1999						
	5/4/1999						
	5/15/1999						
	6/14/1999						
	7/13/1999						
	8/13/1999						
	9/14/1999						
	10/13/1999						
	11/11/1999						
	12/9/1999						
	1/13/2000						
	2/14/2000						
	3/9/2000	3.27	269.45	2.98	246.01	2.94	262.17
	4/11/2000	3.53	269.19	3.17	245.82	3.14	261.97
	5/10/2000	3.58	269.14	3.00	245.99	3.51	261.60
	6/19/2000	4.57	268.15	4.11	244.88	3.18	261.93
	7/10/2000	5.17	267.55	5.76	243.23	3.95	261.16
	10/10/2000	6.19	266.53	7.07	241.92	4.59	260.52
	1/22/2001	3.85	268.87	3.11	245.88	5.84	259.27
						3.38	261.73
						3.81	259.74
						4.02	259.53
						3.79	259.76
						4.56	258.99
						5.92	257.63
						6.26	257.29
						3.63	259.92
						3.64	9.83
						2.44	8.99

AR 031294

West Wall Area Water Level Data

	HC00-B309	HC00-B316	HC00-B317	HC00-B315	HC00-B333
Measuring Point	Depth* Elevation in Feet in Feet	Depth* Elevation in Feet in Feet	Depth* Elevation in Feet in Feet	Depth* Elevation in Feet in Feet	Depth* Elevation in Feet in Feet
Ground Level*	0.00 264.9	0.00 271.1	0.00 259.64	0.00 283.49	
Top of Screen*			246.64	253.49	
Bottom of Screen*			236.64	263.49	
Date:	3/8/1999				
	3/10/1999				
	4/5/1999				
	5/4/1999				
	5/15/1999				
	6/14/1999				
	7/13/1999				
	8/13/1999				
	9/14/1999				
	10/13/1999				
	11/11/1999				
	12/9/1999				
	1/13/2000				
	2/14/2000				
	3/9/2000				
	4/11/2000				
	5/10/2000				
	6/19/2000				
	7/10/2000				
	10/10/2000	9.49 255.41	10.01 261.09		
	1/22/2001	8.58 256.32	8.75 262.35	7.18 252.46	8.03 275.46

AR 031295

ECY00019176

North Safety Area Water Level Data

	AT96-B1	AT96A-B8	AT96A-B10	AT97-B41	AT97-B42	AT97-B57	IC99-B31
Measuring Point	Depth* in Feet	Elevation in Feet	Depth* in Feet	Elevation in Feet	Depth* in Feet	Elevation in Feet	Depth* in Feet
Ground Level*	0.00	407.7	0.00	319.7	0.00	312.2	0.00
Top of Screen*	-0.3	408	-0.3	320	3.2	309	-0.3
Bottom of Screen*	77.7	330	23.7	296	81.2	231	13
	87.7	320	33.7	286	83.2	229	23
Date:							
3/8/1999	--	--	--	Flowing >312	21.21	303.9	--
3/10/1999	dry	--	8.15	311.6	--	--	2.38
4/5/1999	dry	--	8.11	311.6	21.59	303.6	2.41
5/4/1999	dry	--	8.35	311.4	22.17	303.0	2.58
5/15/1999	--	--	--	311.2	22.22	302.9	2.58
6/14/1999	dry	47.86	8.74	311.0	22.58	302.6	2.93
7/13/1999	dry	48.87	8.81	310.9	Decommissioned	--	2.98
8/13/1999	dry	48.10	9.06	310.6	Decommissioned	--	3.11
9/14/1999	dry	48.26	9.44	310.3	Decommissioned	3.10	263.1
10/13/1999	dry	48.49	9.74	310.0	Decommissioned	3.61	262.5
11/11/1999	87.88	319.8	10.00	309.7	Decommissioned	3.72	263.2
12/9/1999	dry	48.88	9.50	310.2	Decommissioned	--	2.23
1/13/2000	dry	49.10	9.18	310.5	Decommissioned	--	2.19
2/14/2000	dry	50.25	9.02	310.7	Decommissioned	--	2.25
3/9/2000	dry	49.05	8.63	311.1	Decommissioned	--	2.38
4/11/2000	dry	48.63	8.65	311.1	Decommissioned	--	2.37
5/9/2000	dry	48.40	8.86	310.8	Decommissioned	0.04	2.72
6/19/2000	dry	48.23	8.91	310.8	Decommissioned	0.46	2.47
7/10/2000	62.93	344.8	9.21	310.5	Decommissioned	1.29	2.75
10/10/2000	dry	48.64	10.71	309.0	Decommissioned	4.0	2.96
1/22/2001	dry	49.31	10.30	309.4	Decommissioned	4.08	3.00
				310.6	Decommissioned	0.58	2.36
				310.6	Decommissioned	2.35.1	263.8

Italics = Estimated

Depth* All depths are below measuring point (NOT below the ground surface)

-- Indicates data not available.

AR 031296

ECY00019177

North Safety Area Water Level Data

Sheet 2 of 5

	HC99-B32		HC99-B33		HC99-B34		HC99-B35		HC99-B36		HC99-B41		HC99-B43A		
	Depth*	Elevation	Depth*	Elevation	Depth*	Elevation	Depth*	Elevation	Depth*	Elevation	Depth*	Elevation	Depth*	Elevation	
	in Feet	in Feet	in Feet	in Feet	in Feet	in Feet	in Feet	in Feet	in Feet	in Feet	in Feet	in Feet	in Feet	in Feet	
Measuring Point	0.00	266.29	0.00	265.65	0.00	267.63	0.00	294.58	0.00	275.03	0.00	330.8	0.00	295.5	
Ground Level*	3.1	263.2	2.9	262.8	2.4	265.2	2.0	292.6	2.4	272.6	3	328	3	29	
Top of Screen*	13.1	253.2	11.9	253.8	7.4	260.2	15.0	279.6	6.4	268.6	28	302.8	27.0	268	
Bottom of Screen*	23.1	243.2	21.9	243.8	17.4	250.2	25.0	269.6	10.4	264.6	38	292.8	37.0	258	
Date:	3/8/1999	3.55	262.74	2.71	262.94	4.72	262.91	4.69	289.89	4.73	270.30	31.87	308.86	--	--
	3/10/1999	3.51	262.78	2.64	263.01	4.68	262.95	5.13	289.45	5.01	270.02	--	--	--	--
	4/5/1999	4.14	262.15	3.19	262.46	5.44	262.19	5.58	289.00	5.83	269.20	32.57	308.16	Under Pressure	30
	5/15/1999	4.75	261.54	2.61	263.04	5.88	261.75	6.48	288.10	6.23	268.80	33.24	307.49	--	--
	6/14/1999	4.83	261.46	3.72	261.93	5.86	261.77	6.79	287.79	6.42	268.61	33.56	307.17	-9.2	304.8
	7/13/1999	5.05	261.24	3.90	261.75	6.12	261.51	7.29	287.29	6.68	268.35	33.77	306.96	-9.5	305.0
	8/13/1999	5.21	261.08	4.09	261.56	6.16	261.47	7.76	286.82	7.85	267.18	33.97	306.76	-10.4	305.9
	9/14/1999	4.77	261.52	3.70	261.95	5.89	261.74	7.79	286.79	6.91	268.12	24.18	306.52	-9.2	304.8
	10/13/1999	3.02	263.27	2.90	262.75	4.32	263.31	6.40	288.18	5.60	269.43	24.29	306.53	-9.5	305.0
	11/11/1999	3.08	263.21	1.44	264.21	4.35	263.28	Destroyed	Destroyed	4.29	270.74	23.06	307.76	-9.7	305.2
	12/9/1999	3.32	262.97	1.65	264.00	4.54	263.09	Destroyed	Destroyed	4.31	270.72	23.00	307.82	-10.1	305.7
	1/13/2000	3.56	262.73	1.81	263.84	4.81	262.82	Destroyed	Destroyed	4.50	270.53	22.68	308.14	-10.1	305.7
	2/14/2000	3.63	262.66	1.82	263.83	4.92	262.71	Destroyed	Destroyed	4.49	270.54	22.62	308.20	-10.4	305.9
	3/9/2000	4.32	261.97	2.48	263.17	5.55	262.08	Destroyed	Destroyed	5.71	269.32	23.16	307.66	-10.6	306.1
	4/11/2000	3.48	262.81	1.91	263.74	4.67	262.96	Destroyed	Destroyed	5.87	269.16	23.38	307.44	-10.3	305.8
	5/9/2000	4.51	261.78	2.69	262.96	5.73	261.90	Destroyed	Destroyed	6.14	268.89	23.76	307.06	-10.1	305.7
	6/19/2000	4.73	261.56	3.00	262.65	5.84	261.79	Destroyed	Destroyed	6.48	268.55	23.94	306.88	-10.1	305.7
	7/10/2000	4.65	261.64	2.80	262.85	5.77	261.86	Destroyed	Destroyed	6.97	268.06	24.53	306.29	-10.1	305.7
	10/10/2000	3.39	262.90	1.37	264.28	4.68	262.95	Destroyed	Destroyed	4.39	270.64	24.08	306.74	-9.7	305.2
	1/22/2001														

AR 031297

ECY00019178

North Safety Area Water Level Data

Sheet 3 of 5

	HC99-B44	HC99-B45	HC99-B46	HC99-B47	HC99-B48	HC99-B50	HC99-B51
	Depth* in Feet	Depth* in Feet	Depth* in Feet	Depth* in Feet	Depth* in Feet	Depth* in Feet	Depth* in Feet
	Elevation in Feet	Elevation in Feet	Elevation in Feet	Elevation in Feet	Elevation in Feet	Elevation in Feet	Elevation in Feet
	in Feet	in Feet	in Feet	in Feet	in Feet	in Feet	in Feet
Measuring Point	0.00	275.82	0.00	332.93	0.00	281.22	0.00
Ground Level*	2.6	271.2	2.1	330.8	2.4	278.8	2.7
Top of Screen*	42.6	233.2	30.1	302.8	7.4	273.8	15.7
Bottom of Screen*	52.6	223.2	40.1	292.8	12.4	268.8	20.7
Date:							
3/8/1999	--	278.59	22.01	310.81	--	--	--
3/10/1999	--	--	--	--	--	--	--
4/5/1999	--	277.79	22.48	310.34	--	--	--
5/4/1999	--	277.36	23.09	309.73	6.26	274.96	--
5/15/1999	--	--	--	--	--	--	--
6/14/1999	--	276.30	23.75	309.07	7.44	273.78	--
7/13/1999	--	276.29	24.17	308.65	6.99	274.23	--
8/13/1999	--	275.86	24.53	308.29	7.56	273.66	--
9/14/1999	--	274.20	24.84	307.98	9.03	272.19	--
10/13/1999	--	275.48	25.21	307.72	8.59	272.63	--
11/11/1999	--	276.91	25.33	307.60	5.12	276.10	--
12/9/1999	4.85	270.97	24.42	308.51	3.48	277.74	6.42
1/13/2000	4.92	270.90	23.85	309.08	3.13	278.09	6.68
2/14/2000	5.10	270.72	23.31	309.62	4.62	276.60	7.17
3/9/2000	5.05	270.77	23.14	309.79	3.51	277.71	7.27
4/11/2000	5.49	270.33	23.41	309.52	6.37	274.85	7.27
5/9/2000	5.38	270.44	23.77	309.16	6.72	274.50	8.109
6/19/2000	5.78	270.04	Decommissioned		7.06	274.16	8.41
7/10/2000	5.98	269.84	Decommissioned		7.81	273.41	8.79
10/10/2000	6.32	269.50	Decommissioned		12.29	268.93	9.61
1/22/2001	5.61	270.21	Decommissioned		4.46	276.76	12.75
							7.35
							280.55
							281.48
							281.22
							280.73
							280.63
							279.81
							279.49
							279.11
							278.29
							275.15
							265.64
							265.80
							265.39
							264.96
							264.91
							264.06
							264.94
							263.63
							263.26
							263.26
							263.26
							265.64
							277.0
							276.7
							277.0
							276.8
							275.8
							275.5
							274.6
							274.0
							270.9
							275.9

AR 031298

ECY00019179

North Safety Area Water Level Data

	HC99-B52	HC99-B54	HC99-B55	HC99-B56	HC99-B57	HC99-B58	HC99-B61
	Depth* in Feet	Depth* in Feet	Depth* in Feet	Depth* in Feet	Depth* in Feet	Depth* in Feet	Depth* in Feet
	Elevation in Feet	Elevation in Feet	Elevation in Feet	Elevation in Feet	Elevation in Feet	Elevation in Feet	Elevation in Feet
Measuring Point	0.00	277.94	0.00	0.00	0.00	0.00	0.00
Ground Level*	2.8	275.8	2.3	2.5	1.8	2.3	2.1
Top of Screen*	7.8	237.8	12.3	6.0	6.8	6.3	9.1
Bottom of Screen*	12.8	227.8	17.3	11.0	11.8	8.3	14.1
Date:	3/8/1999	--	--	--	--	--	--
	3/10/1999	--	--	--	--	--	--
	4/5/1999	--	--	--	--	--	--
	5/4/1999	--	--	--	--	--	--
	5/15/1999	--	--	--	--	--	--
	6/14/1999	--	--	--	--	--	--
	7/13/1999	--	--	--	--	--	--
	8/13/1999	--	--	--	--	--	--
	9/14/1999	--	--	--	--	--	--
	10/13/1999	--	--	--	--	--	--
	11/11/1999	--	--	--	--	--	--
	12/9/1999	4.92	272.91	10.25	3.66	2.56	13.30
	1/13/2000	5.29	272.90	10.32	4.09	2.36	13.58
	2/14/2000	5.83	272.89	10.03	4.25	2.38	9.40
	3/9/2000	5.81	272.88	10.20	4.16	2.50	7.89
	4/11/2000	6.91	272.48	10.97	5.18	2.85	7.62
	5/9/2000	7.36	272.49	11.68	5.51	2.53	7.55
	6/19/2000	8.15	272.13	--	6.15	3.28	8.85
	7/10/2000	9.07	271.96	Decommissioned	6.51	4.00	9.72
	10/10/2000	9.5	271.51	Decommissioned	6.81	3.91	Decommissioned
	1/22/2001	5.3	272.12	Decommissioned	4.91	2.55	Decommissioned

AR 031299

ECY00019180

North Safety Area Water Level Data

Sheet 5 of 5

	IC99-B64	IC99-B65	IC99-B71	IC99-B72	IC99-B73	IC00-B165	IC00-B173
	Depth* in Feet	Depth* in Feet	Depth* in Feet	Depth* in Feet	Depth* in Feet	Depth* in Feet	Depth* in Feet
	Elevation in Feet	Elevation in Feet	Elevation in Feet	Elevation in Feet	Elevation in Feet	Elevation in Feet	Elevation in Feet
Measuring Point	0.00	0.00	0.00	0.00	0.00	0.00	0.00
Ground Level*	2.2	2.5	2.5	2.3	2.1	2.1	2.5
Top of Screen*	12.2	34.5	9.5	12.3	14.1	7.1	12.5
Bottom of Screen*	17.2	44.5	19.5	17.3	24.1	12.1	17.5
Date:							
3/8/1999	--	--	--	--	--	--	--
3/10/1999	--	--	--	--	--	--	--
4/5/1999	--	--	--	--	--	--	--
5/4/1999	--	--	--	--	--	--	--
5/15/1999	--	--	--	--	--	--	--
6/14/1999	--	--	--	--	--	--	--
7/13/1999	--	--	--	--	--	--	--
8/13/1999	--	--	--	--	--	--	--
9/14/1999	--	--	--	--	--	--	--
10/13/1999	--	40.23	14.53	--	--	--	--
11/11/1999	--	40.44	14.60	--	10.38	10.10	283.42
12/9/1999	6.87	307.89	289.93	--	10.10	283.70	283.42
1/13/2000	6.05	307.68	289.86	--	5.35	278.46	288.55
2/14/2000	6.22	308.48	297.26	5.35	4.32	279.49	289.30
3/9/2000	6.31	309.17	297.70	4.32	4.28	279.53	289.30
4/11/2000	7.36	309.61	297.80	4.28	4.34	279.47	289.30
5/9/2000	7.8	309.84	297.74	4.34	4.47	277.75	273.81
6/19/2000	8.15	309.68	296.59	6.06	5.64	277.30	273.80
7/10/2000	8.55	309.26	295.82	6.51	6.36	273.00	273.47
10/10/2000	9.34	308.74	293.86	6.89	7.18	276.92	273.48
1/22/2001	7.1	308.53	293.26	7.08	7.85	276.73	273.25
		307.68	Decommissioned	7.63	10.04	276.18	272.67
		307.76	Decommissioned	5.82	6.00	277.99	270.11
							287.80
							4.34
							274.14
							10.35
							266.4
							9.82
							266
							9.61
							266
							11.12
							265
							11.9
							264
							12.35
							263
							12.66
							263
							13.17
							262
							10.35
							265

AR 031300

ECY00019181

San Safety Area Water Level Data

	AT96-B1	AT96A-B8	AT96A-B10	AT97-B41	AT97-B42	AT97-B57	HC99-B31	HC99-B32	HC99-B33	HC
	Depth* levatio in Feet in Feet	Depth* levatio in Feet in Feet	Depth* levatio in Feet in Feet	Depth* levatio in Feet in Feet	Depth* levatio in Feet in Feet	Depth* levatio in Feet in Feet	Depth* levatio in Feet in Feet	Depth* levatio in Feet in Feet	Depth* levatio in Feet in Feet	Depth* levatio in Feet in Feet
00	407.7	412.7	319.7	312.2	325.2	235.7	266.24	266.29	265.65	0.0
00	-0.3	413	-0.3	309	322	-0.3	263.7	263.2	262.8	2.9
00	77.7	330	296	231	503	13	248.7	253.2	253.8	7.1
00	87.7	320	286	229	298	23	238.7	243.2	243.8	17.1
00	--	--	--	Flowing: 12	303.9	--	263.86	262.74	262.94	4.1
00	dry	311.6	8.15	--	--	--	263.85	262.78	263.01	4.6
00	dry	311.6	8.11	Flowing>312	303.6	--	263.66	262.15	262.46	5.4
00	dry	311.4	8.35	0.91	303.0	--	263.31	261.54	263.04	5.8
00	dry	--	--	--	302.9	2.11	263.26	261.46	261.53	5.8
00	dry	47.86	8.74	1.27	310.9	22.58	263.13	261.24	261.75	6.1
00	dry	48.87	8.81	1.41	310.7	Decommissioned	262.94	261.08	261.95	5.8
00	dry	48.10	9.06	1.57	310.6	Decommissioned	263.27	262.97	262.75	4.3
00	dry	48.26	9.44	1.73	310.4	Decommissioned	264.05	263.21	264.11	4.3
00	dry	48.42	9.74	1.77	310.4	Decommissioned	263.86	262.73	263.84	4.8
00	87.88	319.8	10.00	1.52	310.6	Decommissioned	263.87	262.66	263.83	4.9
00	dry	48.75	364.0	0.72	311.4	Decommissioned	263.99	262.97	263.17	5.5
00	dry	48.88	363.8	0.69	311.5	Decommissioned	263.77	262.81	263.74	4.6
00	dry	49.10	363.6	0.49	311.7	Decommissioned	263.49	261.78	262.76	5.7
00	dry	50.25	362.5	0.88	311.3	Decommissioned	263.28	261.56	262.85	5.8
00	dry	49.05	363.7	0.48	311.7	Decommissioned	263.57	261.64	262.85	5.7
00	dry	48.63	364.1	0.88	311.3	Decommissioned	263.83	262.90	264.28	4.6
00	dry	48.40	364.3	1.01	311.1	Decommissioned	263.52	262.66	263.83	4.9
00	dry	48.23	364.5	1.37	310.9	Decommissioned	263.77	262.81	263.17	5.5
00	62.93	344.8	8.91	1.52	310.5	Decommissioned	263.49	261.78	262.76	5.7
00	dry	48.18	364.5	2.00	310.5	Decommissioned	263.28	261.56	262.85	5.8
00	dry	48.64	364.1	1.58	310.6	Decommissioned	263.57	261.64	262.85	5.7
01	dry	49.31	363.4	1.58	310.6	Decommissioned	263.83	262.90	264.28	4.6

Italics = Estimated

Depth* All depths are below measuring point (NOT below tide surface)

-- Indicates data not available.

ECY00019182

497820\SeatechWaterLevels.x \NFA-404 Area

Safety Area Water Level Data

	HC99-B35	HC99-B36	HC99-B41	HC99-B43A	HC99-B44	HC99-B45	HC99-B46	HC99-B47	HC99-B48
levatio in Feet	Depth* Feet in	Depth* Feet in	Depth* Feet in	Depth* Feet in	Depth* Feet in	Depth* Feet in	Depth* Feet in	Depth* Feet in	Depth* Feet in
267.63	0.00 294.58	0.00 275.03	0.00 330.8	0.00 295.58	0.00 275.82	0.00 285.29	0.00 332.93	0.00 281.22	0.00 270.02
265.2	2.0 292.6	2.4 272.6	3 328	3 293	2.6 273.2	3.1 282.2	2.1 330.3	2.4 278.8	2.4 267.6
260.2	15.0 279.6	6.4 268.6	28 302.8	27.0 268.6	42.6 233.2	8.1 277.2	30.1 302.3	7.4 273.8	9.5 260.1
250.2	25.0 269.6	10.4 264.6	38 292.8	37.0 258.6	52.6 223.2	13.1 272.2	40.1 292.9	12.4 266.8	14.9 255.1
262.91	4.69 289.99	4.73 270.30	31.87 308.86	--	--	6.70 278.59	22.01 310.8	--	--
262.95	5.13 289.45	5.01 270.02	32.57 308.16	--	--	7.50 277.79	22.48 310.34	--	--
262.19	5.58 289.00	5.83 269.20	33.17 307.56	Under Pressure	--	7.93 277.36	23.09 309.73	--	--
261.75	6.48 288.10	6.23 268.80	33.24 307.49	--	--	--	--	6.26 274.96	--
261.77	6.79 287.75	6.42 268.61	33.56 307.17	-9.2 304.81	--	8.99 276.30	23.75 309.07	--	--
261.51	7.29 287.29	6.68 268.35	33.77 306.96	-9.5 305.04	--	9.00 276.29	24.17 308.65	7.44 273.78	--
261.47	7.76 286.82	7.85 267.18	33.97 306.76	-10.4 305.96	--	9.43 275.86	24.53 308.29	6.99 274.23	--
261.74	7.79 286.79	6.91 268.12	24.18 306.52	-9.2 304.81	--	11.09 274.20	24.84 307.99	7.56 273.66	--
263.31	6.40 288.18	5.60 269.43	24.00 306.82	-9.5 305.04	--	9.81 275.48	25.21 307.72	9.03 272.19	--
263.28	Destroyed	4.29 270.74	23.06 307.76	-9.7 305.27	--	8.38 276.91	25.33 307.60	8.59 272.63	--
263.09	Destroyed	4.31 270.72	23.00 307.82	-10.1 305.73	4.85 270.97	6.52 278.77	24.42 308.51	5.12 276.10	--
262.82	Destroyed	4.50 270.53	22.68 308.14	-10.1 305.73	4.92 270.90	7.34 277.95	23.85 309.08	3.48 277.74	4.22 265.80
262.71	Destroyed	4.49 270.54	22.62 308.20	-10.4 305.96	5.10 270.72	7.54 277.75	23.31 309.62	3.13 278.09	4.63 265.39
262.08	Destroyed	3.71 269.32	23.16 307.66	-10.6 306.19	5.05 270.77	7.34 277.95	23.14 309.79	4.52 276.60	5.06 264.96
262.96	Destroyed	5.87 269.16	23.38 307.44	-10.3 305.85	5.49 270.33	8.95 276.34	23.41 309.52	3.51 277.71	5.11 264.91
261.90	Destroyed	6.14 268.89	23.76 307.06	-10.1 305.73	5.38 270.44	9.18 276.11	23.77 309.16	6.37 274.85	5.96 264.06
261.79	Destroyed	6.48 268.55	23.94 306.88	-10.1 305.73	5.78 270.04	9.85 275.44	Decommissioned	6.72 274.50	5.08 264.94
261.86	Destroyed	6.97 268.06	24.53 306.29	-10.1 305.73	5.98 269.84	11.09 274.20	Decommissioned	7.06 274.16	6.39 263.63
262.95	Destroyed	4.39 270.64	24.13 306.74	-9.7 305.27	6.32 269.50	dry	Decommissioned	7.81 273.41	6.76 263.26
					5.61 270.21	7.79 277.50	Decommissioned	12.29 268.93	6.76 263.26
								4.46 276.76	4.38 265.64

ECY00019183

Safety Area Water Level Data

	HC99-B50	HC99-B51	HC99-B52	HC99-B54	HC99-B55	HC99-B56	HC99-B57	HC99-B58	HC99-B61	HC99
	Depth* levatio in Feet in Feet	Depth* levatio in Feet in Feet	Depth* levatio in Feet in Feet	Depth* levatio in Feet in Feet	Depth* levatio in Feet in Feet	Depth* levatio in Feet in Feet	Depth* levatio in Feet in Feet	Depth* levatio in Feet in Feet	Depth* levatio in Feet in Feet	Depth* levatio in Feet in Feet
0	0.00 287.9	0.00 278.56	0.00 287.34	0.00 277.94	0.00 289.81	0.00 295.25	0.00 296.08	0.00 293.60	0.00 303.94	0.00
1	2.7 285.2	2.7 275.9	2.8 284.6	2.2 275.8	2.3 287.5	2.5 292.7	1.8 294.3	2.3 291.3	2.1 301.8	2.3
2	15.7 272.2	15.7 262.9	7.8 279.6	40.2 237.8	12.3 277.5	6.0 289.2	6.8 289.3	6.3 287.3	9.1 294.8	6.3
3	20.7 267.2	20.7 257.9	12.8 274.6	50.2 227.9	17.3 272.5	11.0 284.2	11.8 284.3	8.3 285.3	14.1 289.3	8.3
4	--	--	--	--	--	--	--	--	--	--
5	--	--	--	--	--	--	--	--	--	--
6	--	--	--	--	--	--	--	--	--	--
7	--	--	--	--	--	--	--	--	--	--
8	--	--	--	--	--	--	--	--	--	--
9	--	--	--	--	--	--	--	--	--	--
10	6.42 281.48	1.48 277.08	4.92 282.42	5.03 272.91	10.25 279.56	3.66 291.59	2.56 293.52	dry	13.30 290.64	dry
11	6.68 281.22	1.81 276.75	5.29 282.05	5.04 272.90	10.32 279.59	4.09 291.16	2.36 293.72	dry	9.40 294.54	dry
12	7.17 280.73	1.52 277.04	5.83 281.51	5.05 272.89	10.03 279.78	4.25 291.00	2.38 293.70	dry	7.89 296.05	dry
13	7.27 280.63	1.75 276.81	5.81 281.53	5.06 272.88	10.20 279.61	4.16 291.09	2.50 293.58	dry	7.62 296.32	dry
14	8.09 279.81	2.73 275.83	6.91 280.43	5.46 272.48	10.97 278.84	5.18 290.07	2.85 293.23	dry	7.55 296.39	dry
15	8.41 279.49	3.02 275.54	7.35 279.98	5.45 272.49	11.68 278.15	5.51 289.74	2.53 293.55	dry	8.85 295.09	dry
16	8.79 279.11	3.88 274.68	8.15 279.19	5.81 272.15	--	6.15 289.10	3.28 292.80	dry	9.72 294.22	dry
17	9.61 278.29	4.49 274.07	9.07 278.27	5.98 271.96	Decommissioned	6.51 288.74	4.00 292.08	Decommissioned	--	Decommissioned
18	12.75 275.15	7.62 270.94	9.5 277.84	6.43 271.51	Decommissioned	6.81 288.44	3.91 292.17	Decommissioned	8.55	Decommissioned
19	7.35 280.55	2.63 275.93	5.3 287.04	5.82 272.12	Decommissioned	4.91 290.34	2.55 293.53	Decommissioned	9.34	Decommissioned

ECY00019184

1 Safety Area Water Level Data

Elevation in Feet	HC99-B65		HC99-B71		HC99-B72		HC99-B73		HC00-B165		HC00-B173	
	Depth in Feet	levation in Feet	Depth in Feet	levation in Feet	Depth in Feet	levation in Feet	Depth in Feet	levation in Feet	Depth in Feet	levation in Feet	Depth in Feet	levation in Feet
294.2	0.00	348.12	0.00	304.46	0.00	283.81	0.00	293.80	0.00	278.48	0.00	276.13
292.0	2.5	345.6	2.5	302.0	2.3	281.6	2.1	291.7	2.1	276.38	2.5	273.63
282.0	34.5	313.6	9.5	295.0	12.3	271.6	14.1	279.7	7.1	271.4	12.5	263.6
277.0	44.5	303.6	19.5	285.0	17.3	266.6	24.1	289.7	12.1	266.4	17.5	258.6
39	--	--	--	--	--	--	--	--	--	--	--	--
39	--	--	--	--	--	--	--	--	--	--	--	--
39	--	--	--	--	--	--	--	--	--	--	--	--
39	--	--	--	--	--	--	--	--	--	--	--	--
39	--	--	--	--	--	--	--	--	--	--	--	--
39	--	--	--	--	--	--	--	--	--	--	--	--
39	--	--	--	--	--	--	--	--	--	--	--	--
39	40.23	307.89	14.53	289.93	--	--	--	--	--	--	--	--
39	40.44	307.68	14.60	289.86	--	--	10.38	283.12	--	--	--	--
39	39.64	308.48	7.20	297.26	--	--	10.11	283.70	--	--	--	--
30	288.2	38.95	309.17	6.76	297.70	5.35	278.46	5.25	288.55	--	--	--
30	288.0	38.51	309.61	6.66	297.80	4.32	279.49	4.50	289.30	--	--	--
30	287.9	38.28	309.84	6.72	297.74	4.34	279.47	4.50	289.30	4.67	273.81	9.82
30	286.8	38.44	309.68	7.87	296.59	6.06	277.75	4.7	289.33	4.68	273.80	9.61
30	286.4	38.86	309.26	8.64	295.92	6.51	277.30	5.64	288.16	5.0	273.47	11.12
30	286.1	39.38	308.74	10.60	295.86	6.89	276.92	6.36	287.44	5.00	273.48	11.9
30	285.7	39.59	308.53	11.20	293.26	7.08	276.73	7.18	286.62	5.23	273.25	12.35
30	284.9	40.44	307.68	Decommissioned	Decommissioned	7.63	276.18	7.85	285.95	5.81	272.67	12.66
31	287.1	40.3	307.76	Decommissioned	Decommissioned	5.82	277.99	10.04	283.76	8.37	270.1	13.17
								6.00	297.80	4.34	274.14	10.35
												263.78

1

ECY00019185

457820\SeaTachWaterLevels.xls\NEA-404 Area

AR 031304

Borrow Area 4 Water Level Data

	A4-B1 Depth* (feet)	A4-B2 Depth* (feet)	A4-B4 Depth* (feet)	A4-B5 Depth* (feet)	A4-B6 Depth* (feet)
Top of Monument	-0.50	392.84	-0.35	371.26	-0.26
Measuring Point	0.00	392.34	0.00	370.96	0.00
Ground Level*	1.94	390.4	2.36	368.3	2.72
Top of Screen*	109.44	282.90	97.86	298.10	118.52
Bottom of Well	119.44	272.90	108.06	287.85	128.72
(ATD)	98.0	292.4			
12/28/94	100.2	290.2	--	--	--
1/26/95	102.3	288.1	--	--	--
(ATD)			97.8	363.00	104.3
5/15/98	--	--	--	--	--
5/22/98	100.98	291.36	93.29	292.07	107.37
6/2/98	100.70	291.64	92.98	292.38	106.92
6/15/99	--	--	90.71	294.65	104.97
7/13/99	--	--	91.09	294.27	105.23
8/13/99	--	--	91.42	293.94	105.47
9/14/99	--	--	91.82	293.54	105.80
10/13/99	--	--	92.27	293.09	106.17
11/11/99	100.20	292.14	92.60	292.76	106.61
12/10/99	--	--	93.13	292.23	106.87
1/12/00	--	--	93.48	291.88	107.15
2/15/00	101.10	291.24	93.71	291.65	107.35
3/13/00	101.03	291.31	93.58	291.78	107.23
4/12/00	101.07	291.27	93.55	291.81	107.22
5/10/00	101.01	291.33	93.46	291.90	107.21
6/21/00	100.96	291.38	93.34	292.02	107.19
7/11/00	100.95	291.39	93.34	292.02	107.17
10/13/00	101.21	291.13	93.79	291.57	107.44
1/23/01	101.67	290.67	94.52	290.84	108.01

Italics = Estimated

Depth* All depths are below measuring point (NOT below the ground surface)

-- Indicates data not available.

ECY00019186

AR 031305

Borrow Area 3 Water Level Data

AGI Borings **Hart Crowser Borings**

	A3-B3		A3-B7		A3-B8		A3-B9		A3-B10		A3-B11	
	Depth* (feet)	Elevation (feet)	Depth* (feet)	Elevation (feet)	Depth* (feet)	Elevation (feet)	Depth* (feet)	Elevation (feet)	Depth* (feet)	Elevation (feet)	Depth* (feet)	Elevation (feet)
Top of Monume	-0.90	248.94	NOT SURVEYED		-0.35	283.22	-0.55	272.83	-0.30	321.44	-0.75	350.90
Measuring Poi	0.00	248.04	0.00	317.0	0.00	282.87	0.00	272.28	0.00	321.14	0.00	350.15
Ground Level*	1.84	246.2	2.00	315.0	2.37	280.5	2.28	270.0	2.54	318.6	1.75	348.4
Top of Screen	38.8	209.2	94.5	222.5	71.8	211.1	53.8	218.5	87.5	233.6	133.0	217.2
Bottom of Wel	50.8	197.2	104.5	212.5	82.3	200.6	64.2	208.1	97.8	223.3	143.3	206.9
12/28/94	35.1	211.1	87.3	227.7	--	--	--	--	--	--	--	--
1/26/95	33.8	212.4	86.6	228.4	--	--	--	--	--	--	--	--
(ATD)												
5/15/98	--	--	--	--	51.09	231.78	41.25	231.03	88.16	232.98	120.55	229.60
5/22/98	29.94	218.10	--	--	51.16	231.71	41.15	231.13	88.16	232.98	120.35	229.80
6/2/98	30.02	218.02	--	--	51.17	231.70	41.11	231.17	88.13	233.01	120.39	229.76
4/23/99												
4/27/99												
5/5/99												
6/14/99	28.28	219.76	--	--	50.13	232.74	39.69	232.59	87.01	234.13	119.32	230.83
7/13/99	29.10	218.94	--	--	49.66	233.21	40.13	232.15	88.79	232.35	120.06	230.09
8/13/99	29.93	218.11	--	--	50.48	232.39	40.89	231.39	89.50	231.64	120.79	229.36
9/14/99	29.71	218.33	--	--	51.03	231.84	41.21	231.07	88.67	232.47	120.93	229.22
10/13/99	31.40	216.64	--	--	51.80	231.07	41.82	230.46	89.09	232.05	121.27	228.88
11/11/99	31.96	216.08	--	--	52.66	230.21	41.92	230.36	88.62	232.52	120.14	230.01
12/10/99	31.96	216.08	--	--	52.27	230.60	41.99	230.29	88.35	232.79	120.51	229.64
1/12/00	30.09	217.95	--	--	--	--	41.30	230.98	87.57	233.57	119.71	230.44
2/15/00	30.54	217.50	--	--	51.15	231.72	41.23	231.05	87.60	233.54	119.75	230.40
3/13/00	29.78	218.26	--	--	50.53	232.34	40.44	231.84	87.18	233.96	119.35	230.80
4/12/00	29.20	218.84	--	--	50.5	232.37	40.69	231.59	87.56	233.58	119.78	230.37
5/10/00	29.57	218.47	--	--	50.95	231.92	40.97	231.31	87.89	233.25	120.12	230.03
6/21/00	30.38	217.66	--	--	52.01	230.86	41.94	230.34	89.09	232.05	121.34	228.81
7/11/00	30.83	217.21	--	--	52.74	230.13	42.47	229.81	89.63	231.51	121.88	228.27
10/13/00	33.16	214.88	--	--	56.16	226.71	44.60	227.68	91.10	230.04	123.27	226.88
1/23/01	35.00	213.04	--	--	56.77	226.10	44.96	227.32	90.99	230.15	123.10	227.05

Italics = Estimated

Depth* All depths are below measuring point (NOT below the ground surface)

-- Indicates data not available.

Top of Monume	
Measuring Poi	
Ground Level *	
Top of Screen	
Bottom of Wel	
	12/28/94
	1/26/95
	(ATD)
	5/15/98
	5/22/98
	6/2/98
	4/23/99
	4/27/99
	5/5/99
	6/14/99
	7/13/99
	8/13/99
	9/14/99
	10/13/99
	11/11/99
	12/10/99
	1/12/00
	2/15/00
	3/13/00
	4/12/00
	5/10/00
	6/21/00
	7/11/00
	10/13/00
	1/23/01

Borrow Area 1 Water Level Data

AGL Borings

	AGL Borings				Hart Crowser Borings			
	A1-B3-94 Depth* Elevation in Feet in Feet	A1-B9-94 Depth* Elevation in Feet in Feet	A1-B10-99 Depth* Elevation in Feet in Feet	A1-B11-99 Depth* Elevation in Feet in Feet	A1-B12-99 Depth* Elevation in Feet in Feet			
Top of Monument (Monument)	-0.25 304.67	-0.25 279.29	-0.68 273.30	-0.35 322.41	-0.25 324.78			
Measuring Point of Casing)	0.00 304.42	0.00 279.04	0.00 272.90	0.00 322.06	0.00 324.53			
Ground Level (Stick-Up)	1.90 302.5	1.52 277.5						
Top of Screen (below GS)	43.0 259.5	53.0 224.5	59.0 213.9	55.0 267.1	79.0 245.5			
Bottom of Well (below GS)	53.5 249.0	63.0 214.5	69.0 203.9	65.0 257.1	89.0 235.5			
Water Levels								
12/28/94	30.5 272.02	49.9 227.62						
1/26/95	29.5 273.02	48.7 228.82						
(ATD)								
2/16/99			52.7 220.20	41.0 281.06	62.0 262.53			
2/19/99	28.57 275.85	47.34 231.70	52.8 220.10	41.25 280.81	61.1 263.43			
5/5/99	28.94 275.48	46.71 232.33	53.10 219.80	41.08 280.98	61.55 262.98			
6/14/99	29.22 275.20	47.60 231.44	53.87 219.03	40.84 281.22	60.56 263.97			
7/15/99	29.65 274.77	48.24 230.80	53.65 219.25	40.84 281.22	59.90 264.63			
8/13/99	30.00 274.42	48.71 230.33	54.20 218.70	41.23 280.83	60.04 264.49			
9/14/99	30.21 274.21	49.20 229.84	54.70 218.20	41.52 280.54	60.24 264.29			
10/13/99	30.52 273.90	49.52 229.52	54.99 217.91	41.79 280.27	60.33 264.20			
11/11/99	30.85 273.57	49.36 229.68	55.50 217.40	42.19 279.87	60.71 263.82			
12/10/99	30.16 274.26	49.00 230.04	55.62 217.28	42.60 279.46	61.60 262.93			
1/12/00	29.10 275.32	48.65 230.39	55.16 217.74	41.97 280.09	61.30 263.23			
2/15/00	28.84 275.58	48.40 230.64	54.31 218.59	41.26 280.80	60.96 263.57			
3/10/00	28.45 275.97	47.99 231.05	53.85 219.05	41.23 280.83	61.32 263.21			
4/12/00	28.52 275.90	48.08 230.96	53.34 219.56	40.92 281.14	61.09 263.44			
5/10/00	28.79 275.63	48.30 230.74	53.40 219.50	40.76 281.30	60.58 263.95			
6/21/00	29.56 274.86	49.12 229.92	53.83 219.07	40.64 281.42	60.05 264.48			
7/11/00	29.78 274.64	49.52 229.52	54.71 218.19	41.28 280.78	60.25 264.28			
10/13/00	30.89 273.53	50.94 228.10	55.09 217.81	41.49 280.57	60.30 264.23			
1/23/01	30.94 273.48	51.00 228.04	56.79 216.11	42.79 279.27	61.16 263.37			
			56.95 215.95	42.58 279.48	61.72 262.81			

Notes:

- 1) AGI Borings have stick-up monuments
- 2) Hart Crowser borings are completed with flush mc4) Measuring Point is top of PVC c
- 3) Water levels are measured as depths below the Me5) -- Indicates data not availab

Borrow Area 1 Water Level

Hart Crowser Borings

	A1-B12S-99	A1-B13-99	A1-B14-99
	Depth* Elevation in Feet in Feet	Depth* Elevation in Feet in Feet	Depth* Elevation in Feet in Feet
Top of Monument (Monument)	-0.40 324.64	-0.58 288.57	-0.45 283.25
Measuring Point of Casing)	0.00 324.24	0.00 287.99	0.00 282.80
Ground Level (Stick-Up)			
Top of Screen (below GS)	59.0 265.2	58.9 229.1	55.0 227.8
Bottom of Well (below GS)	64.0 260.2	69.2 218.8	65.0 217.8
Water Levels			
12/28/94			
1/26/95			
(ATD)	61.5 262.74	62.5 225.49	53.0 229.80
2/16/99	-- --	41.9 246.09	52.6 230.20
2/19/99	61.26 262.98	40.33 247.66	53.41 229.39
5/5/99	60.53 263.71	39.76 248.23	52.44 230.36
6/14/99	59.93 264.31	40.33 247.66	53.17 229.63
7/15/99	59.97 264.27	40.96 247.03	53.16 229.64
8/13/99	60.03 264.21	41.46 246.53	53.80 229.00
9/14/99	60.12 264.12	41.75 246.24	54.15 228.65
10/13/99	60.41 263.83	42.20 245.79	54.22 228.58
11/11/99	60.72 263.52	42.20 245.79	54.27 228.53
12/10/99	60.93 263.31	41.92 246.07	53.91 228.89
1/12/00	60.85 263.39	41.30 246.69	53.27 229.53
2/15/00	61.06 263.18	41.03 246.96	53.28 229.52
3/10/00	60.95 263.29	40.48 247.51	52.86 229.94
4/12/00	60.55 263.69	40.46 247.53	52.83 229.97
5/10/00	60.20 264.04	40.66 247.33	52.93 229.87
6/21/00	60.18 264.06	41.52 246.47	53.63 229.17
7/11/00	60.17 264.07	42.00 245.99	54.13 228.67
10/13/00	60.84 263.40	43.51 244.48	55.38 227.42
1/23/01	61.49 262.75	43.36 244.63	55.15 227.65

AR 031310

Casing
File.

497820\SeaTacWaterLevel.xls

ECY00019191

Elements of Shallow Groundwater Movement

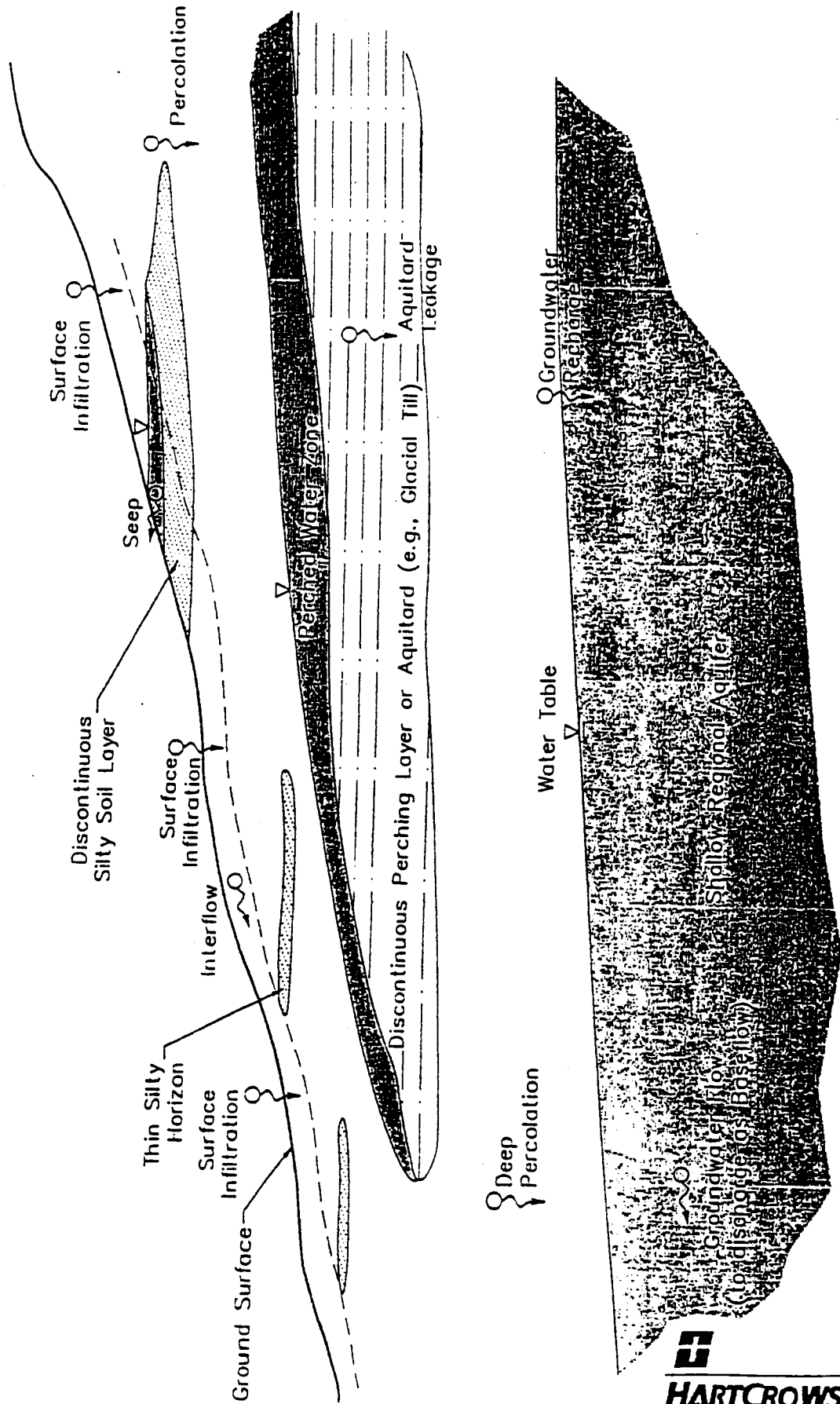

HARTCROWSER
 J-4978-08 7/99
 Figure 4

AR 031311

ECY00019192

MSE Wall Schematic

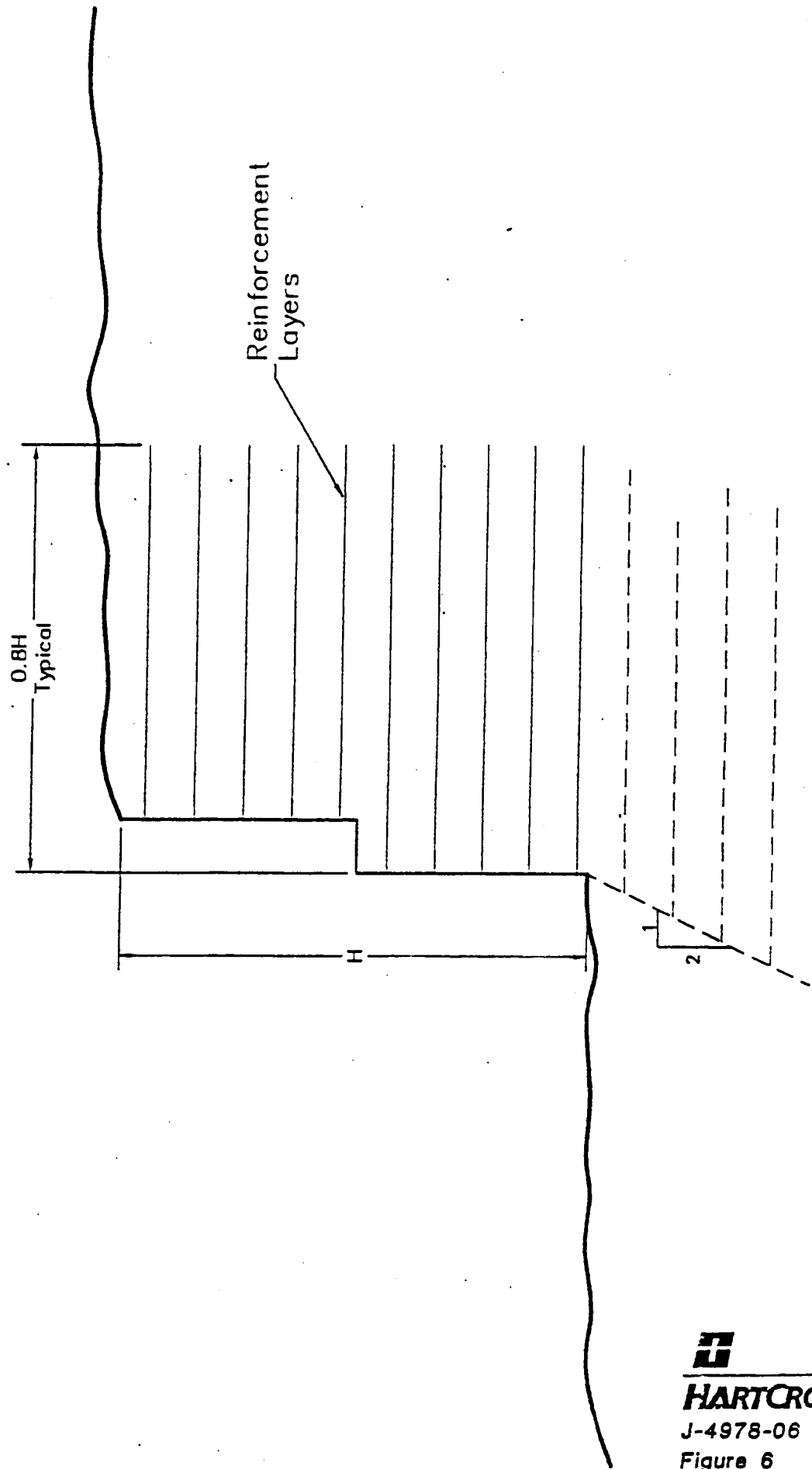

AR 031312

Conceptual Zoned Embankment Cross Sections

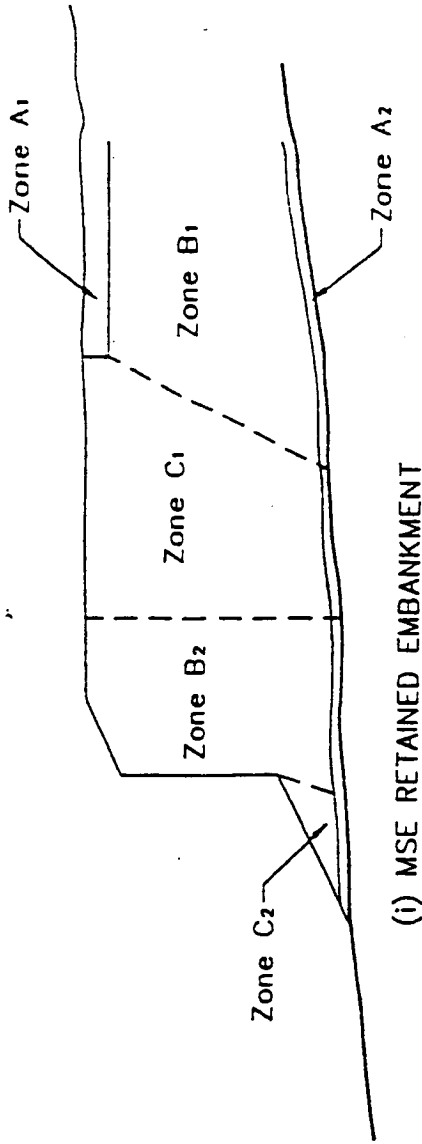

(i) MSE RETAINED EMBANKMENT

EMBANKMENT ZONES

- A1 PAVEMENT SUBGRADE
- A2 DRAINAGE
- B1 PAVEMENT SUPPORT
- B2 MSE REINFORCING
- C1 COMMON EMBANKMENT
- C2 COMMON EMBANKMENT, SLOPE FACE
- D NON-STRUCTURAL FILL

NOTE: DRAINAGE LAYER CONFIGURATION VARIES, SEE FIGURES 8 AND 9.

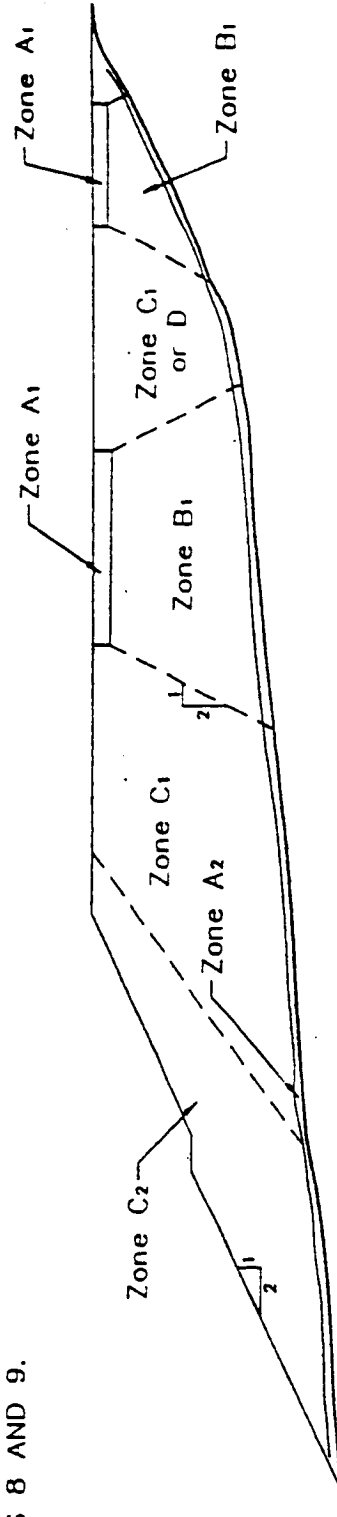

(ii) NOMINAL 2H:1V EMBANKMENT

Extent of Overexcavation for Replacement of Foundation Soils

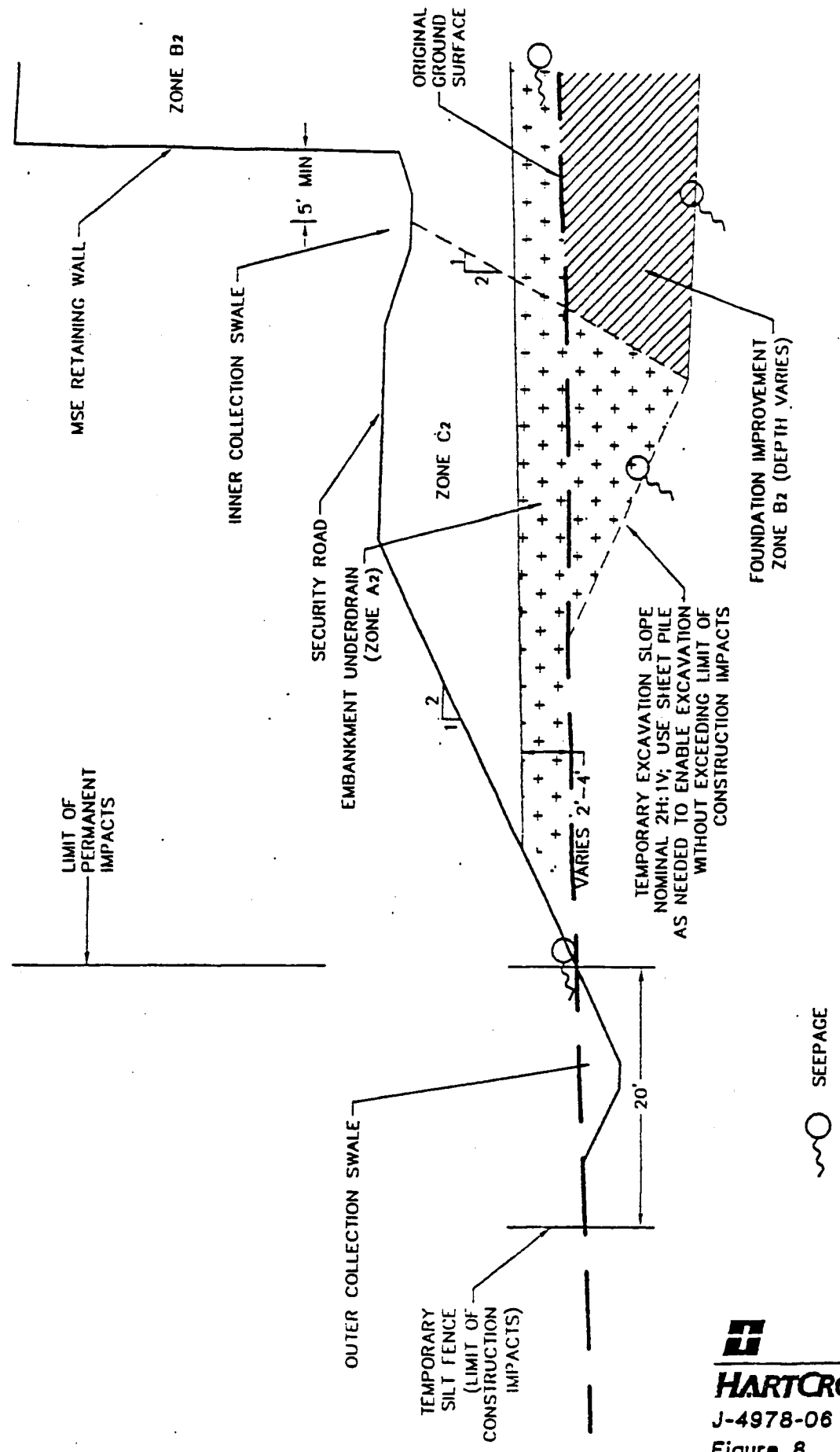

AR 031314

Hydraulic Connection between Wetland Fill and Embankment Underdrain

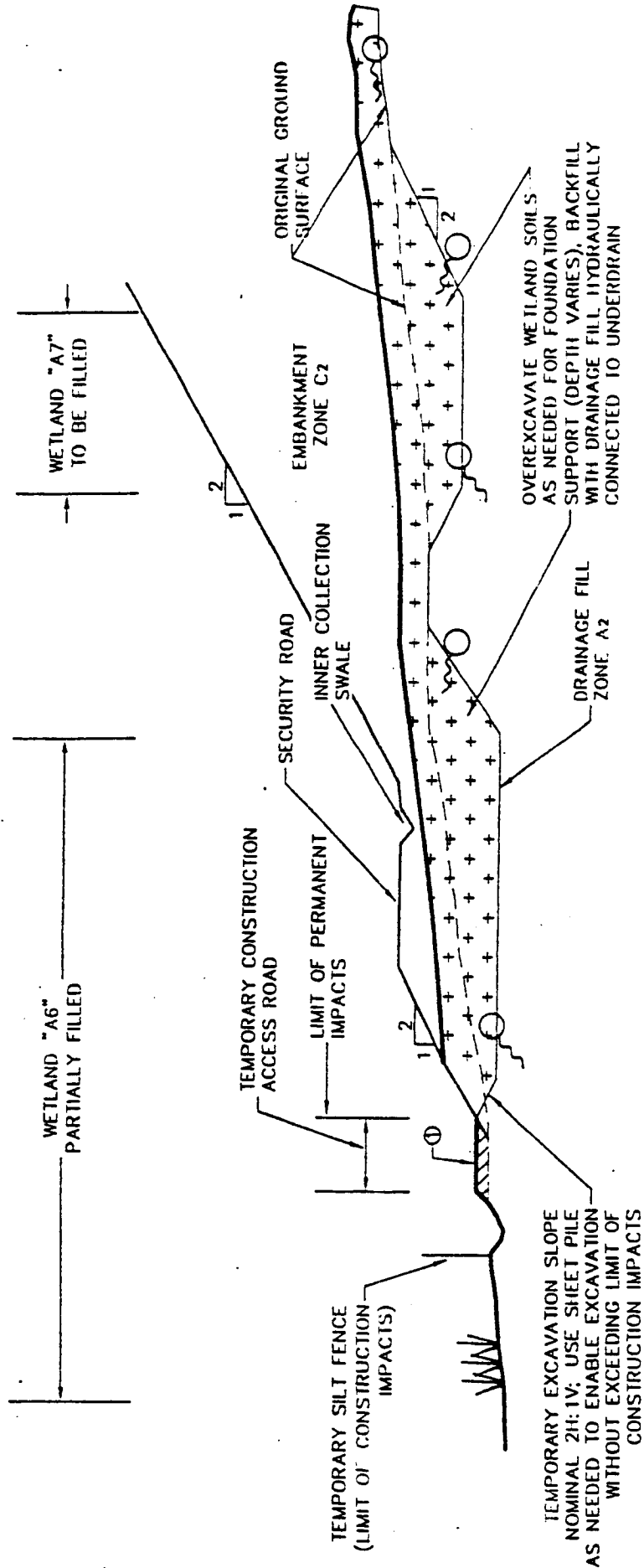

⊙ TEMPORARY ROAD FILL TO BE REMOVED AFTER CONSTRUCTION

○ SEEPAGE



HARTCROWSER

J-4978-06 7/99

Figure 9

AR 031315

ECY00019196

Water Balance Schematic between Stations 175+00 and 185+00 (Typical MSE Wall)

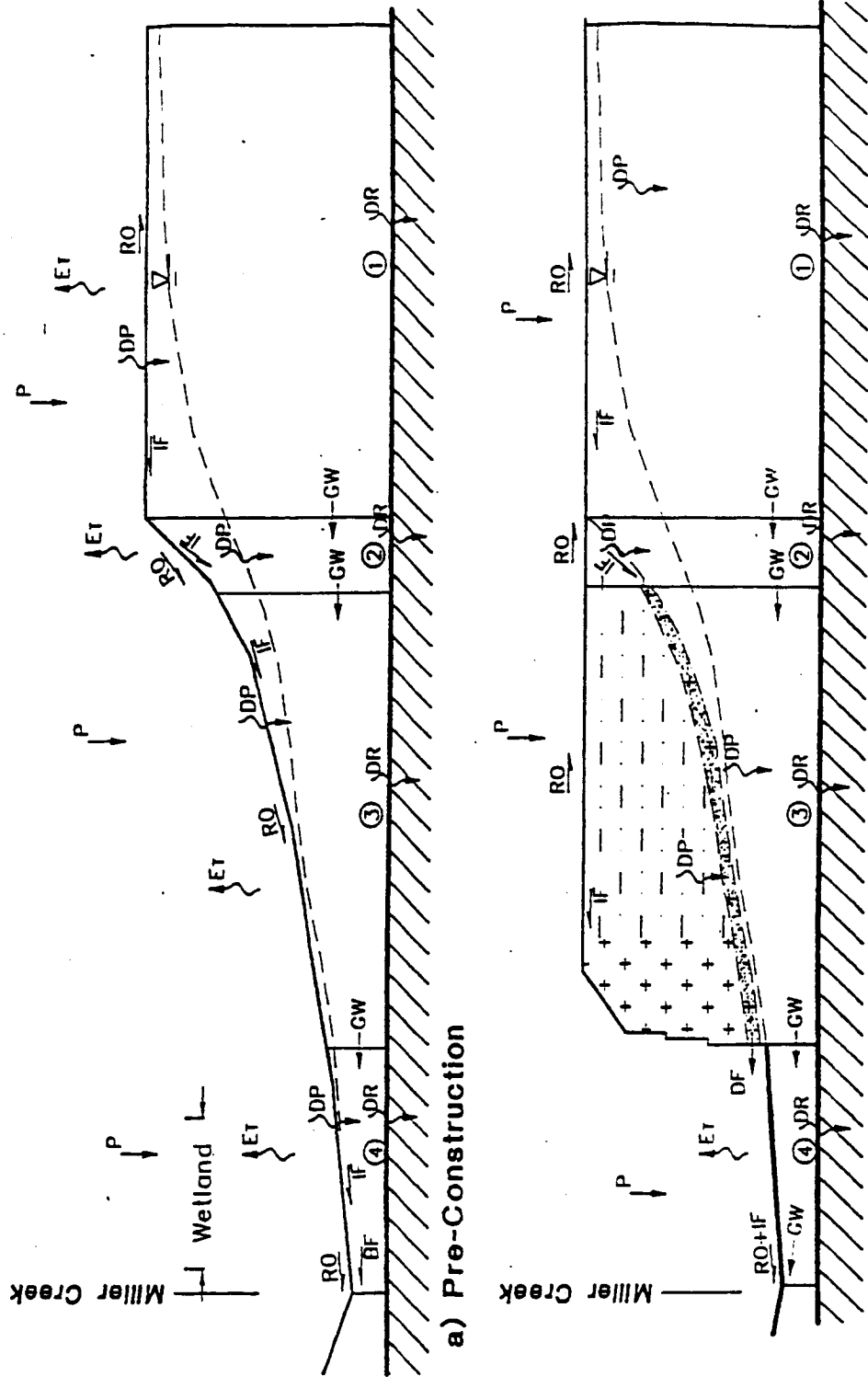

- ④ Block Number
- P Precipitation
- ET Evapotranspiration
- RO Runoff
- IF Interflow
- DP Deep Percolation
- GW Groundwater Flow
- DF Drainage Flow
- ▽ Water Table
- DR Deep Recharge
- ▨ Drainage Layer
- New Embankment
- + + Free-draining Backfill

AR 031316

HARTCROWSE
J-4978-06 6/99
Figure B-1

b) Post-Construction (with MSE Wall and Internal Drainage Layer)

Not to Scale

Water Balance Schematic Between Stations 185+00 and 215+00 (Typical 2H:1V Embankment)

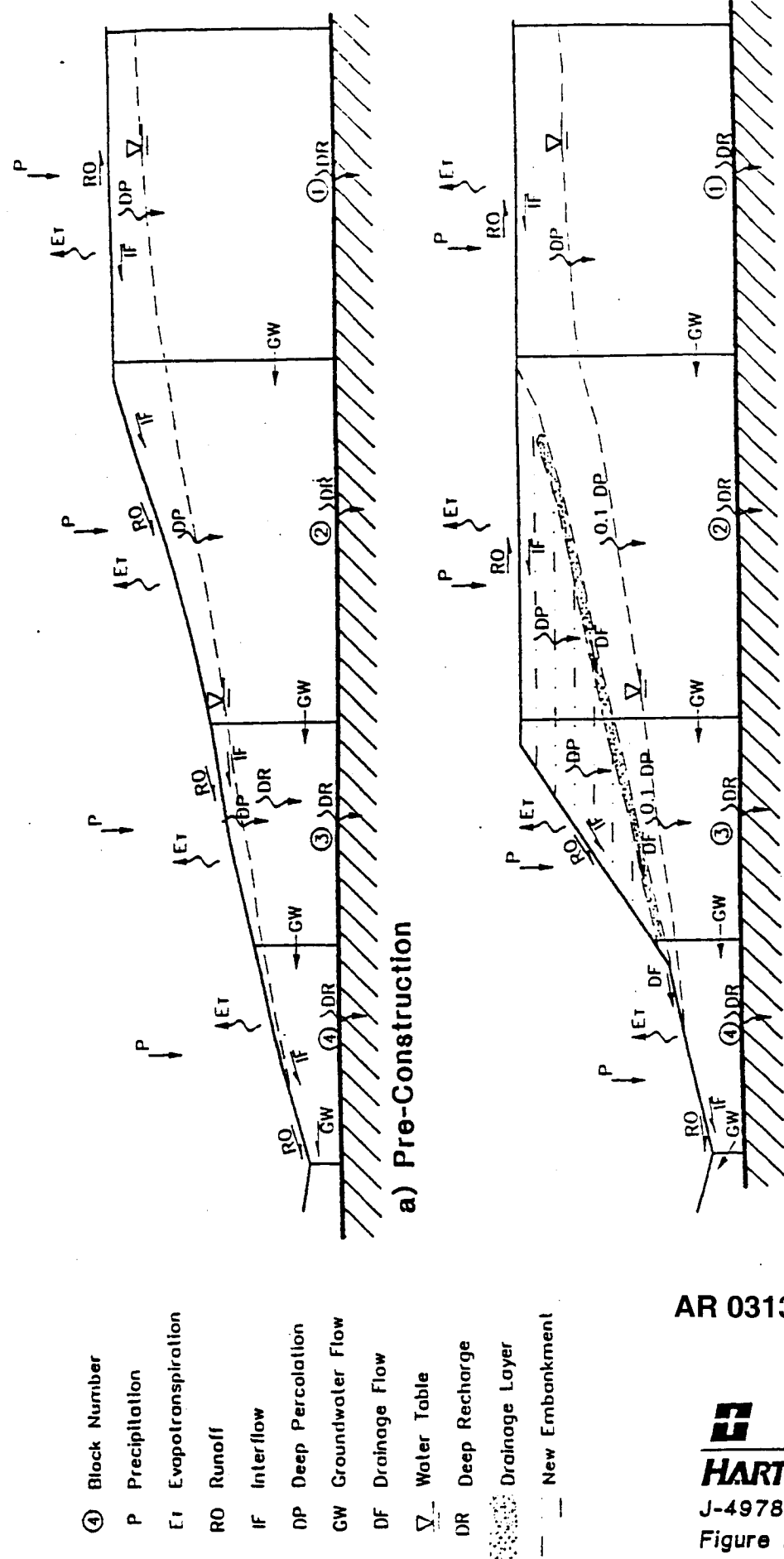

- ④ Block Number
- P Precipitation
- ET Evapotranspiration
- RO Runoff
- IF Interflow
- DP Deep Percolation
- GW Groundwater Flow
- DF Drainage Flow
- ∇ Water Table
- DR Deep Recharge
- Drainage Layer
- New Embankment

a) Pre-Construction

b) Post-Construction

AR 031317

J-4978-08 7/99
Figure B-2

Not to Scale

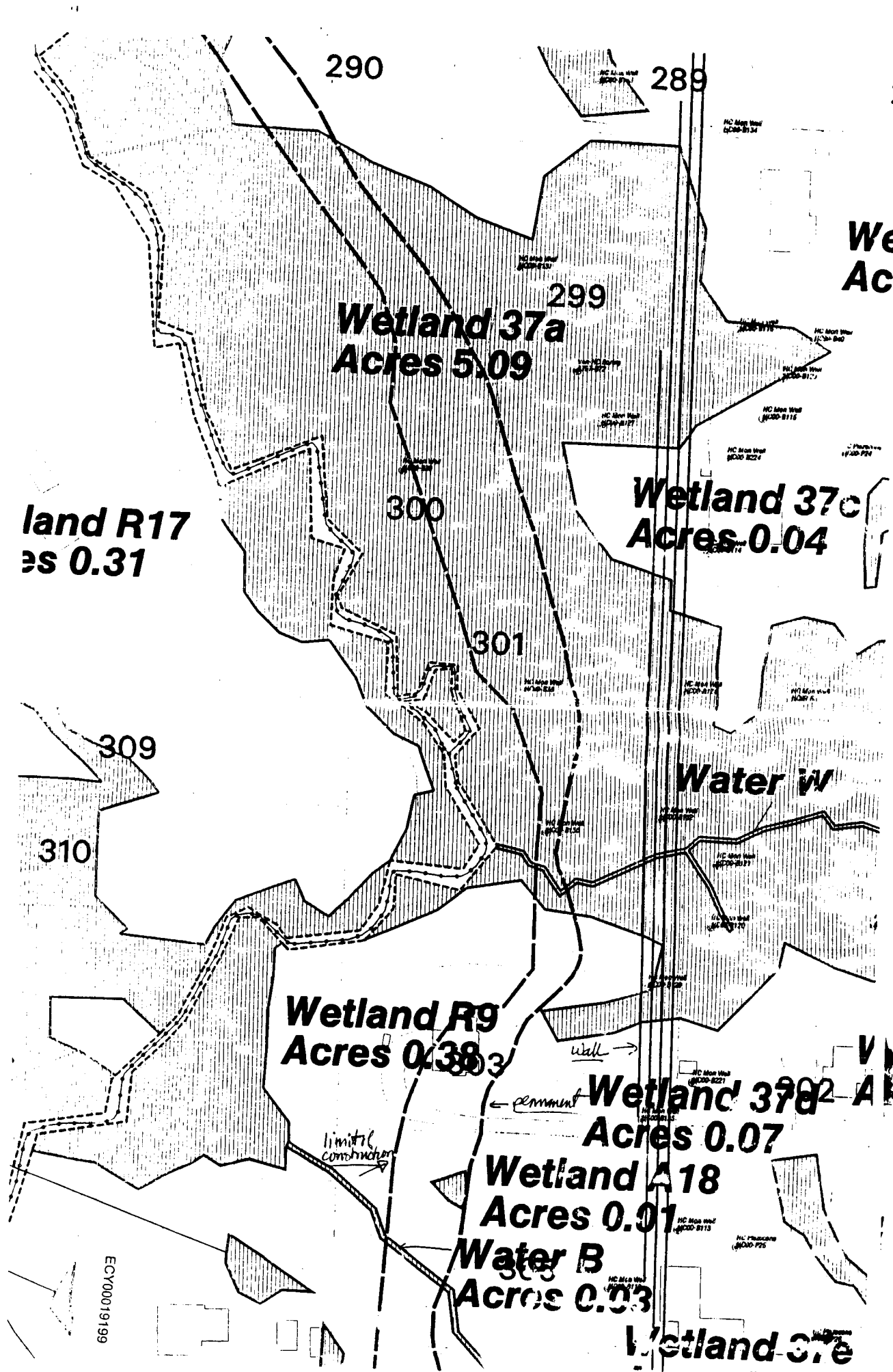

land R17
Acres 0.31

Wetland 37a
Acres 5.09

Wetland 37c
Acres 0.04

Wetland R9
Acres 0.38

Wetland 37b
Acres 0.07

Wetland A18
Acres 0.01

Water B
Acres 0.03

Wetland 37e

We
Ac

Water w

ECY00019199

AR 031318

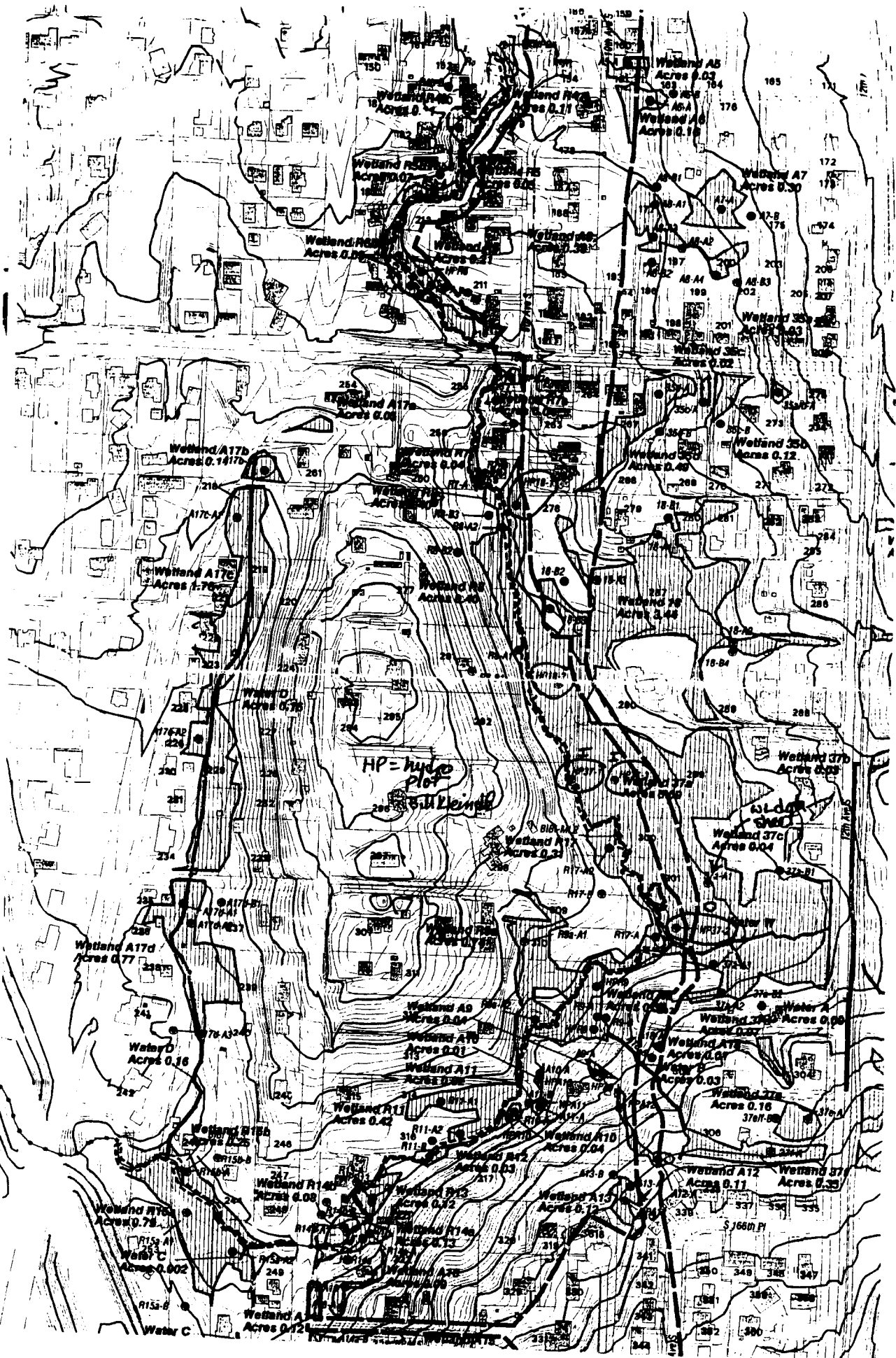

ECY00019200

AR 031319