

7/01 09:32 FAX 425 848 7098

DEPT OF ECOLOGY

/2001 14:33 FAX 3604077154

Ecology TCP

002  
002

www.hartcrowser.com

**HARTCROWSER**  
ivering smarter solutions

December 11, 2001

Anchorage

State of Washington  
Department of Ecology  
ATTN: Notice of Environmental Remedial Action  
Toxics Cleanup Program  
PO Box 47600  
Olympia, WA 98504-7600

Boston

Chicago

Re: Washington State Sales Tax Exemption & Business & Occupation Tax Credit for  
Environmental Remedial Action Projects  
J-7600000

Denver

To Whom It May Concern

Please find enclosed for you action, the signed and completed Department of Revenue  
Form 41s (Professional Certification Confirming Environmental Remedial Action and  
Owner/Agency Certification of Environmental Remedial Action) for Notification of  
Environmental Remedial Action.

Fairbanks

Copies of this same documentation have already been forwarded to the Taxpayer Account  
Administration, Department of Revenue, State of Washington. Should you have any  
questions please don't hesitate to call me at (206) 324-9530.

Jersey City

Sincerely,

Juneau

HART CROWSER, INC.

  
THOMAS B. NICHOLS  
Senior Associate  
Corporate Quality Manager

Long Beach

Exhibit 290  
Date 2/7/02  
Witness CLARK  
Diana Mills Court Reporter

Portland

Seattle

AR 019740





## OWNER/AGENCY CERTIFICATION OF ENVIRONMENTAL REMEDIAL ACTION

This Certification must be accompanied by either an Environmental Professional Certification (Rev 41 0061) or a copy of an enforcement order, agreed order, or consent decree signed by the Washington State Department of Ecology or the United States Environmental Protection Agency. On 8 1/2 x 11 paper, please include a copy of the County Assessor's parcel map or a similar map showing the property and surrounding area.

1. Location of the subject property:

Corner NE 4th Street and 108th Ave.  
Street Address

Belleve  
City

King  
County



Property Tax Parcel Number

2. This Certification is provided by:

- Owner of the subject property
- Washington State Department of Ecology
- U.S. Environmental Protection Agency

3. The proposed environmental remedial action, as that term is defined in Chapter 308, Laws of 1998, to be conducted upon the subject property is one of the following: (check one box only)

- Conducted independently and in a manner consistent with the requirements of the Model Toxics Control Act, Chapter 70.105D RCW (MTCA).
- Conducted independently at a designated Superfund site and in a manner consistent with the requirements of the Comprehensive Environmental Response, Compensation and Liability Act, 42 USC 9601 et seq. (CERCLA).
- Conducted to comply with an enforcement order, agreed order, or consent decree issued by the Department of Ecology pursuant to MTCA.
- Conducted to comply with an enforcement order, consent order, or consent decree issued by the United States Environmental Protection Agency pursuant to CERCLA.
- Conducted by the Department of Ecology or its authorized contractor pursuant to MTCA.
- Conducted by the United States Environmental Protection Agency or its authorized contractor pursuant to CERCLA.



**ATTACHMENT A**

The site is located at the corner of NE 4<sup>th</sup> Street and 108<sup>th</sup> Ave., Bellevue, WA.

While preliminary environmental studies conducted by others did not identify TPH contamination, "suspect" soil was discovered at The Summit site on 5 Oct 00, during excavation. Prior to this discovery, approximately 1,500 tons of suspected petroleum-contaminated soils were transported from The Summit site to the Port of Seattle Third Runway Project.

On 6 Oct 00, Hart Crowser collected twelve soil samples from the excavation site. Chemical laboratory test results of the submitted soil samples indicated that the soil contained detectable concentrations of total petroleum hydrocarbons (TPH), including gasoline (12 to 150 mg/kg); ethylbenzene (82 to 320 mg/kg); xylenes (59 to 650 mg/kg); and diesel/fuel oil (41 to 5,800 mg/kg).

Based on the results of chemical tests, a soil profile was submitted for transportation and thermal treatment of the petroleum-contaminated soils at CSR Associated in Everett, WA. The soil profile was approved and transportation of soil commenced on 6 Oct 00. Based on information obtained from the construction company, approximately 1,540 tons of petroleum-contaminated soil from the Port of Seattle Third Runway Project were transported to CSR Associated on 6 and 7 Oct 00. Additionally, approximately 6,700 tons of petroleum-contaminated soil was transported from the Summit Ridge to CSR Associated between 6 and 10 Oct 00.

In addition to the areas of petroleum-contaminated soils already encountered at the site, it is important to note that the top layer of soil (approximately 10 feet) on the site is fill which may have additional unidentified environmental concerns. The representatives who will be on site during construction will use "common sense criteria" for selecting appropriate stockpiles for the miscellaneous fill.

Following the initial discovery of suspect PCS, the site owner retained Hart Crowser to characterize the material and oversee subsequent excavation actions.

Hart Crowser's remediation efforts directly related to Bentall Enterprises, The Summit project are:

<u>Project Number</u>	<u>Date</u>	<u>Description of Work</u>
7263-00	12 Oct 00	Soil Removal Summary letter for The Summit, Bellevue, WA. Discusses discovery, sampling and analysis, and removal of petroleum-contaminated soil (PCS).
7263-00	12 Oct 00	Excavation Contingency Plan, Bentall Summit Ridge Project, Bellevue, WA
7263-00	16 Oct 00	Health and Safety Plan, Summit Ridge Project, Bentall Enterprises, Bellevue, WA

7263-01	6 Nov 00	Soil Removal Summary letter Oct 12-24, 00, for The Summit, Bellevue, WA. Discusses environmental oversight activities related to petroleum-contaminated soils (PCS) conducted between 12 & 24 Oct 00.
7263-01	13 Dec 00	Soil Removal Summary letter 2 Nov 00, for The Summit, Bellevue, WA. Discusses environmental oversight activities related to petroleum-contaminated soils (PCS) conducted on 2 Nov 00.
7263-01	13 Dec 00	Soil Removal Summary letter Nov 21-22, 00, for The Summit, Bellevue, WA. Discusses environmental oversight activities related to identification of suspected petroleum-contaminated soils (PCS) conducted on 21 and 22 Nov 00.
7263-01	1 Mar 01	Report of Independent Cleanup Action dtd., 1 Mar 01, for The Summit, 10885 NE 4 <sup>th</sup> Street, Bellevue, WA. Summarizes the soil cleanup activities performed at the reference site during reconstruction of a new high-rise building in downtown Bellevue, WA

# Route to Hospital Map

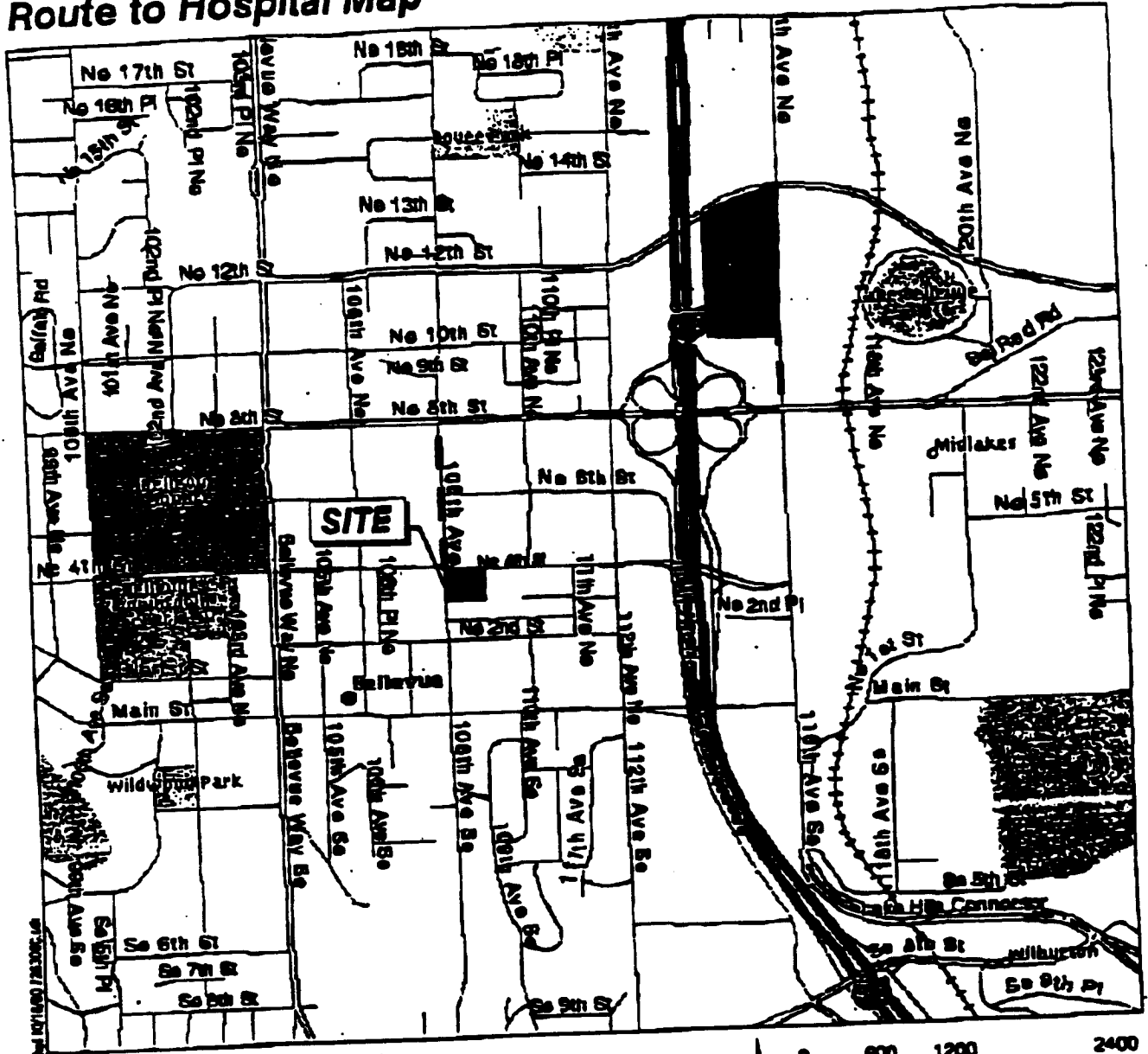

**Site**  
Corner of 108th Avenue and NE 4th Street  
Bellevue, WA 98004

**Overtake Hospital**  
1035 116th Avenue NE  
Bellevue, WA 98004-4604

**Directions:**  
Start out going Northeast on 108TH AVE NE towards NE 6TH STREET. (0.2 miles)  
Turn RIGHT onto NE 8TH STREET. (0.5 miles)  
Turn LEFT onto 116TH AVE. NE. (0.1 mile)



FIELD REPORT  
SITE SKETCH

23 & 24 OCTOBER  
2000

# Site and Exploration Plan

9.24.10/24/00 8-1 (revised/checked) 11/13/2000

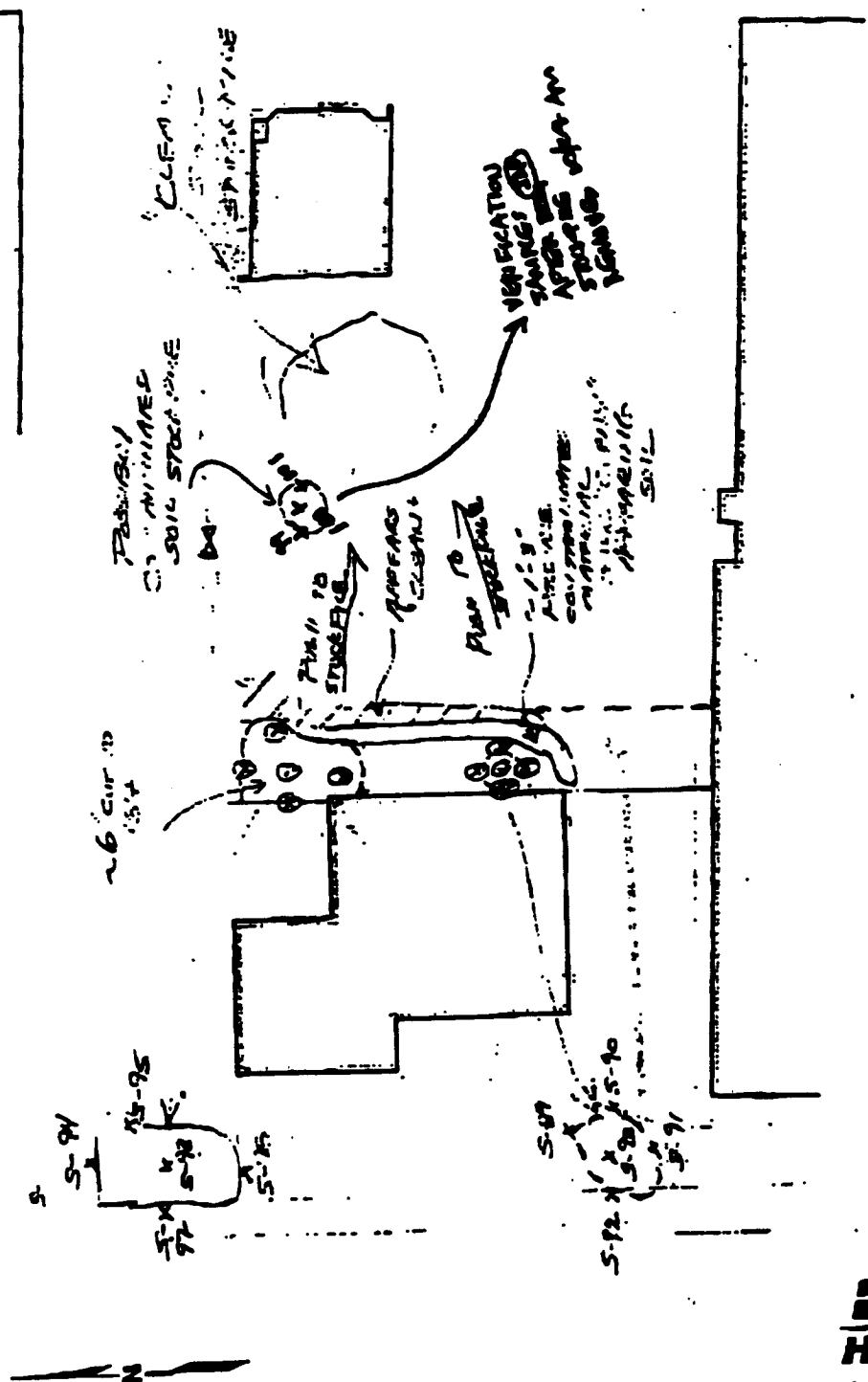

Note: Some map prepared from electronic file provided by Perichalagon Associates Consulting Engineers, Inc. entitled "8889A1A.dwg".

**HARTCROWSER**  
 J-7268 10/00  
 Figure 6



• 8-1 Soil Sample Location and Designation



# Site and Exploration Plan Samples Collected October 5 and 6, 2000 (S-1 through S-17)

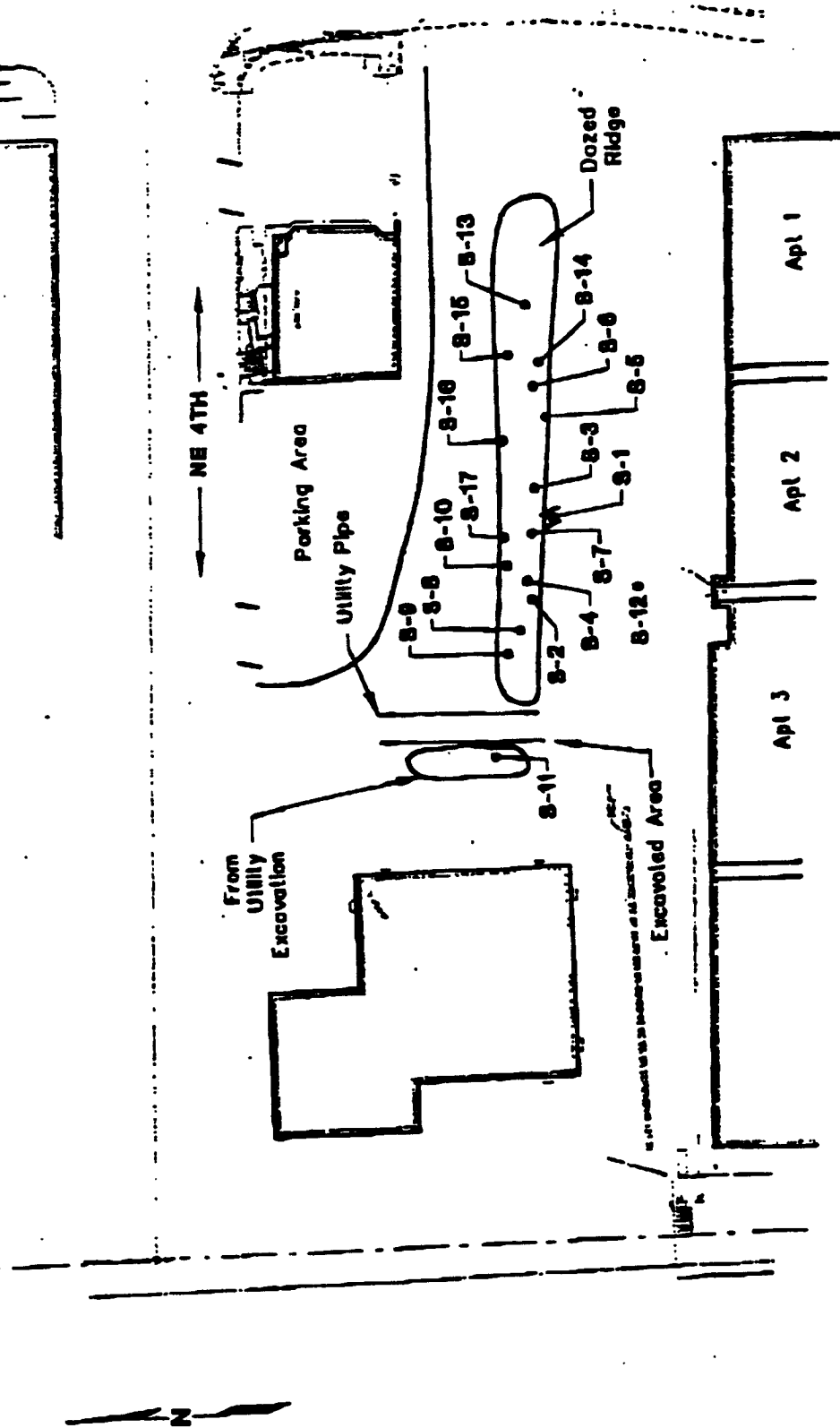

**HARTCROWSER**  
J-7263 10/00  
Figure 1

• S-1 Soil Sample Location and Designation

Note: This map prepared from electronic file provided by Peshalagon Associates Consulting Engineers, Inc. entitled "9656A.1A.dwg".

Scale in Feet  
0 80 160