



Seattle-Tacoma  
International  
Airport



# Capital Improvement Projects Update

Highline Forum | March 24, 2021





**South Satellite  
Renovation  
Opening 2029**

**AMEX Lounge  
Opening 2022**

**C-1 Building  
Opening 2027**

**NorthSTAR  
Opening 2021**

**Duty Free  
Opening 2025**

**Widen Arrival  
Drives  
Completed 2025**

**A Concourse  
Lounge Expansions  
Opening 2023**

**North Main  
Terminal Renovation  
Opening 2025**

**International  
Arrivals Facility  
Opening 2021**

**Terminal Security  
Enhancements  
Completed 2023**

# International Arrivals Facility (IAF)

Opening 2021



**INTERNATIONAL CORRIDOR**

**PEDESTRIAN WALKWAY**

**GRAND HALL**







# North Satellite Renovation (NorthSTAR)

Opening 2021







# New AMEX Club

Completing 2022

# AMEX Club | 2022





reception



bar / cafe



lounge

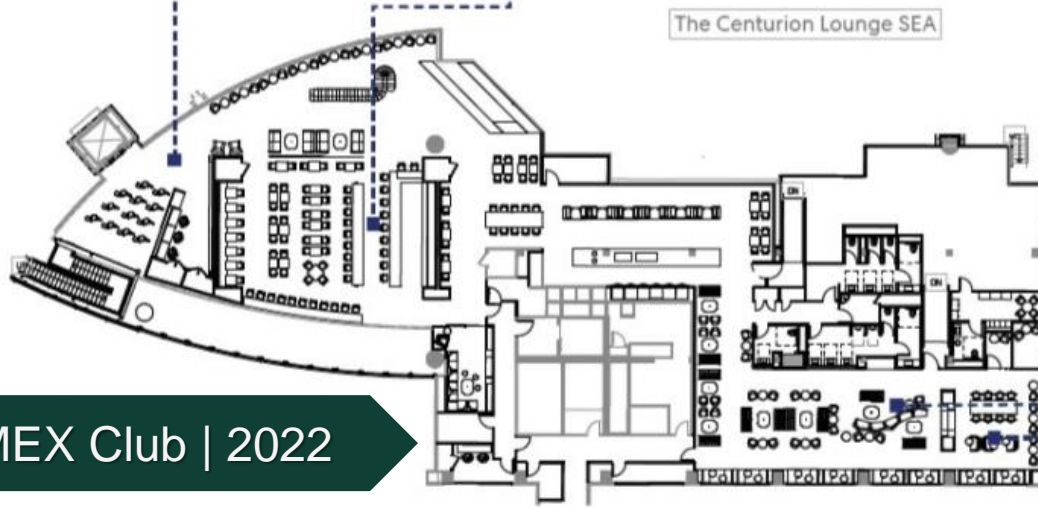

The Centurion Lounge SEA



workspace

AMEX Club | 2022

# Concourse A Lounge Expansion Projects

Opening 2023

# Lounge Expansions | 2023

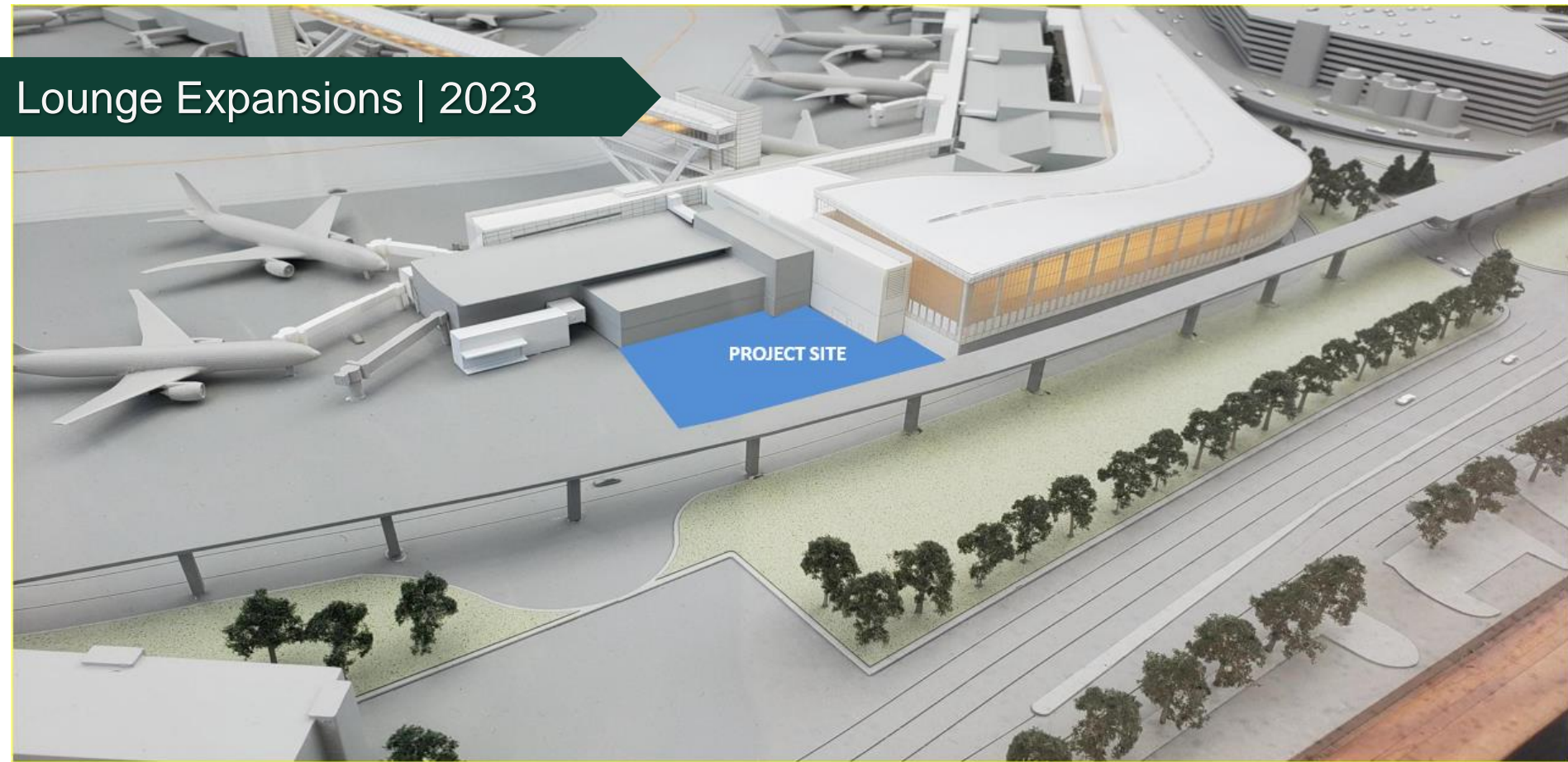

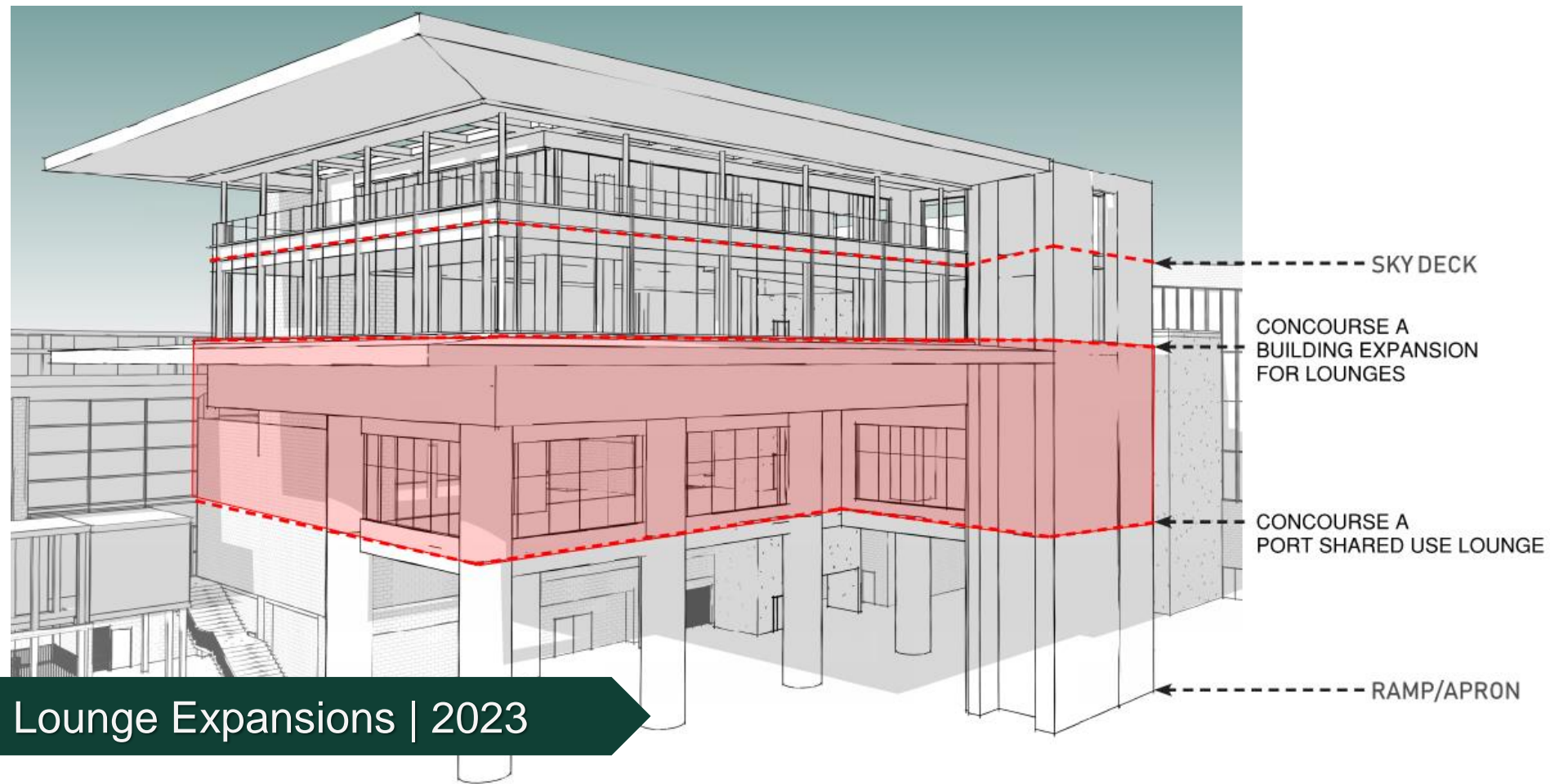

# Lounge Expansions | 2023



# Terminal Security Enhancements

Completing 2023

# Terminal Security Enhancements | 2023

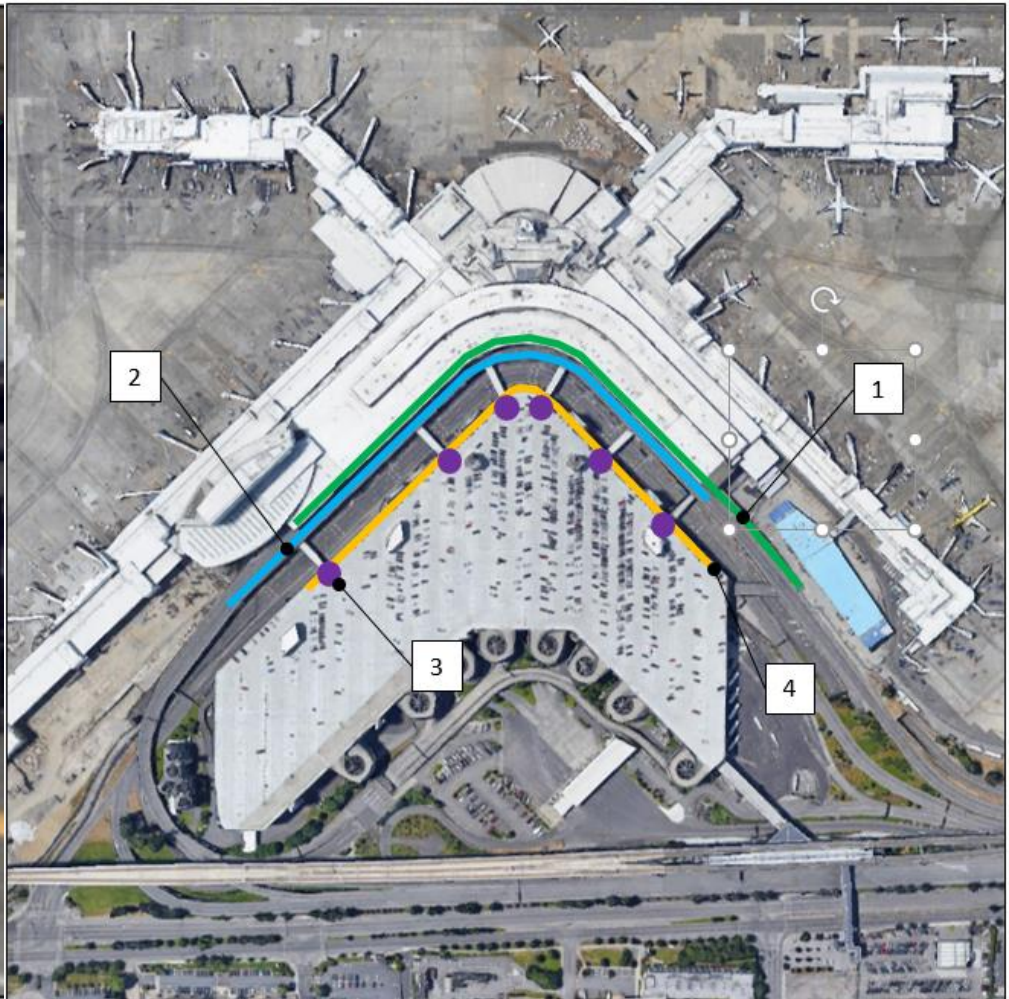

# Terminal Security Enhancements | 2023





# New Duty Free

## Opening 2025

# Duty Free | 2025

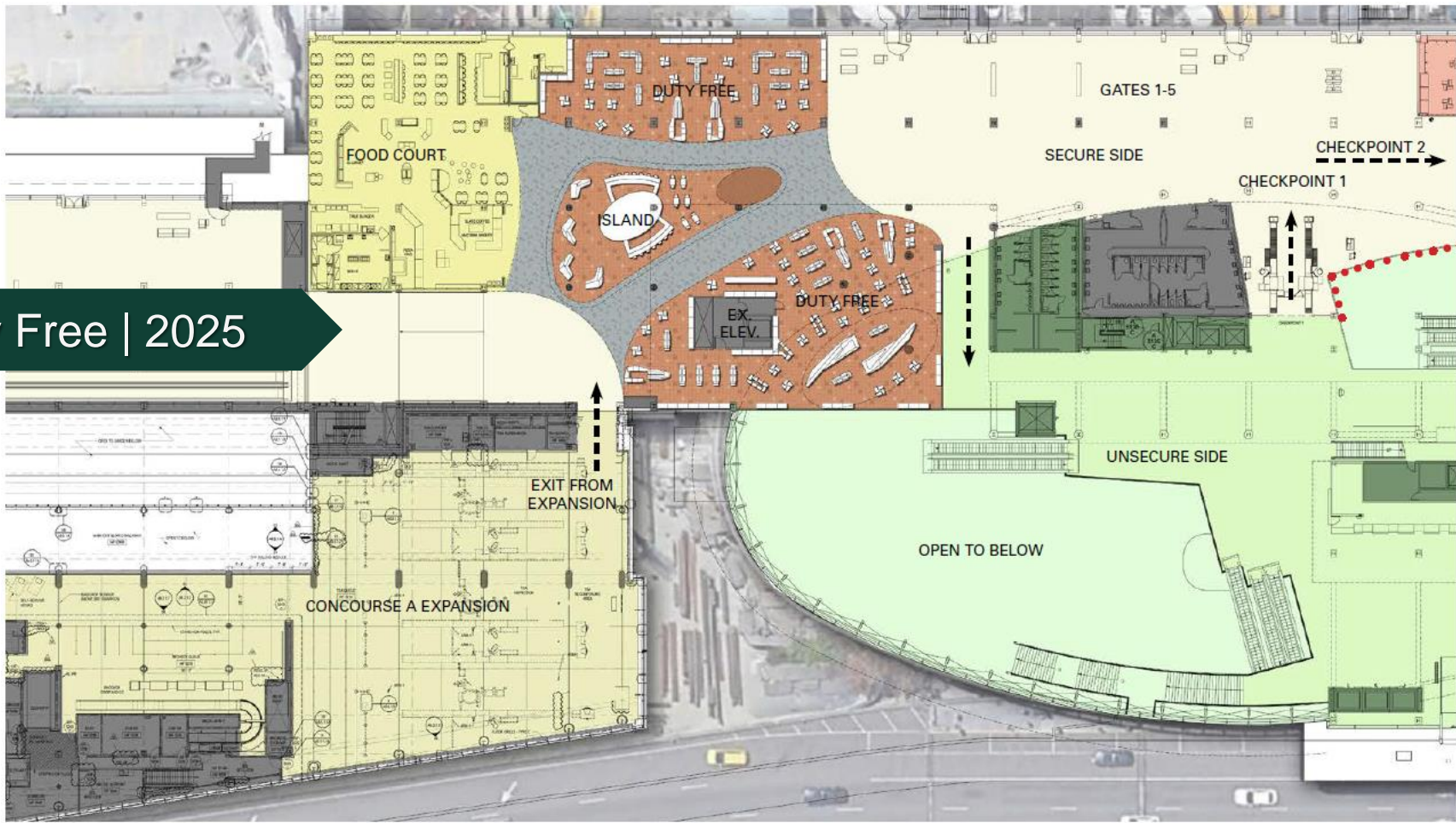

# Duty Free | 2025



# North Main Terminal Renovation

Completing 2025

# North MT Renovation | 2025





# North MT Renovation | 2025



# Widen Arrival Drives

Completed 2025

# Widen Arrival Drives | 2025



**Legend:**

- Future Air Cargo Road
- Existing Air Cargo Road
- Future Departures Drive
- Existing Departures Drive
- Future Arrivals Drive
- Existing Arrivals Drive
- Future Main Garage Access

# Widen Arrival Drives | 2025



# C-1 Building Expansion

Opening 2027

# C-1 Building Expansion | 2027



# C-1 Building Expansion | 2027



Woods Bagot

SEA C-1 BUILDING EXPANSION

# South Satellite Renovation (SSAT Reno)

Opening 2029



# SSAT Renovation | 2029





SSAT Renovation | 2029

# Questions?



**SEA**

Seattle-Tacoma  
International  
Airport



Operated by the  
Port of Seattle

FlySEA.org

